

Frisking Area :8.97 sqm
Lobby Area :6.57 sqm
Office Area :25.42 sqm
Sorting Area :18.78 sqm
Strong room passage :7.63 sqm
Strong room Area :49.79 sqm
Manager Room : 14.82 sqm
Dining Room : 4.83 sqm
Guard Room 1 : 11.27 sqm
Passage :8.54 sqm
<b>Total area :- 156.62 sqm</b>
<b>1685.23sft</b>

Revisions				
S.No	Rev : Date	Remarks	Sign	Check
	17-01-18			

Scale :	NTS	Date :	11-03-2024
DC :		Dealt :	
Checked :		Drawn By :	Sujesh
Drawing No :		Job no :	

ALL DIEMENSIONS ARE IN CENTIMETERS

Title : CURRENCY CHEST PROPOSED LAYOUT -4

Name of work:  
ALAPPUZHA B.J ROAD CURRENCY CHEST

Clients Signature:-

Client :  
CANARA BANK  
B.J ROAD BRANCH  
ALAPPUZHA

Architects Signature & seal :-

Architect :  
*Prima Arch*

Head office  
(Architect, CA-84 8733,REG Valuer-F-3047)  
359 - E, 1st Floor  
Convent Road, Cherthala - 688 524  
PH - 0478 - 2820159  
E-mail primaarch@gmail.com

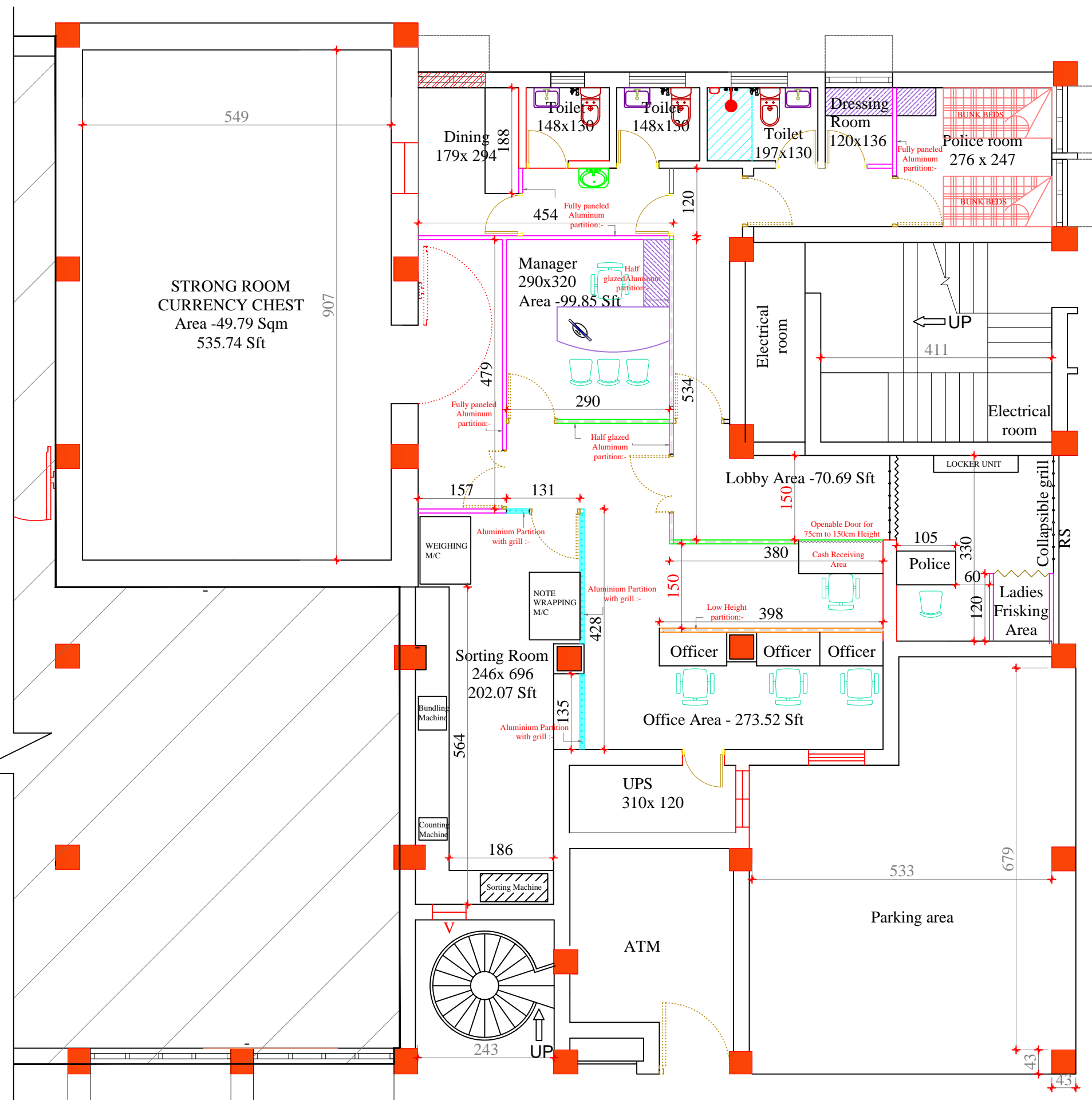

GROUND FLOOR PLAN