

OPTION-01

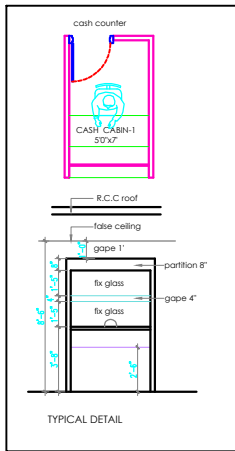

NOTES:
 ALL DIMENSIONS ARE TO BE CHECKED AND CO-RELATED WITH THE RELEVANT ARCHITECTURAL & STRUCTURAL DRAWINGS AND ANY AMBIGUITY SHALL BE IMMEDIATELY BROUGHT TO THE NOTICE OF THE ARCHITECTS BEFORE COMMENCEMENT OF THE WORK. THIS DRAWING IS THE PROPERTY OF ATTIK ARCHITECTS AND IS NOT TO BE COPIED OR USED WITHOUT THEIR PERMISSION.

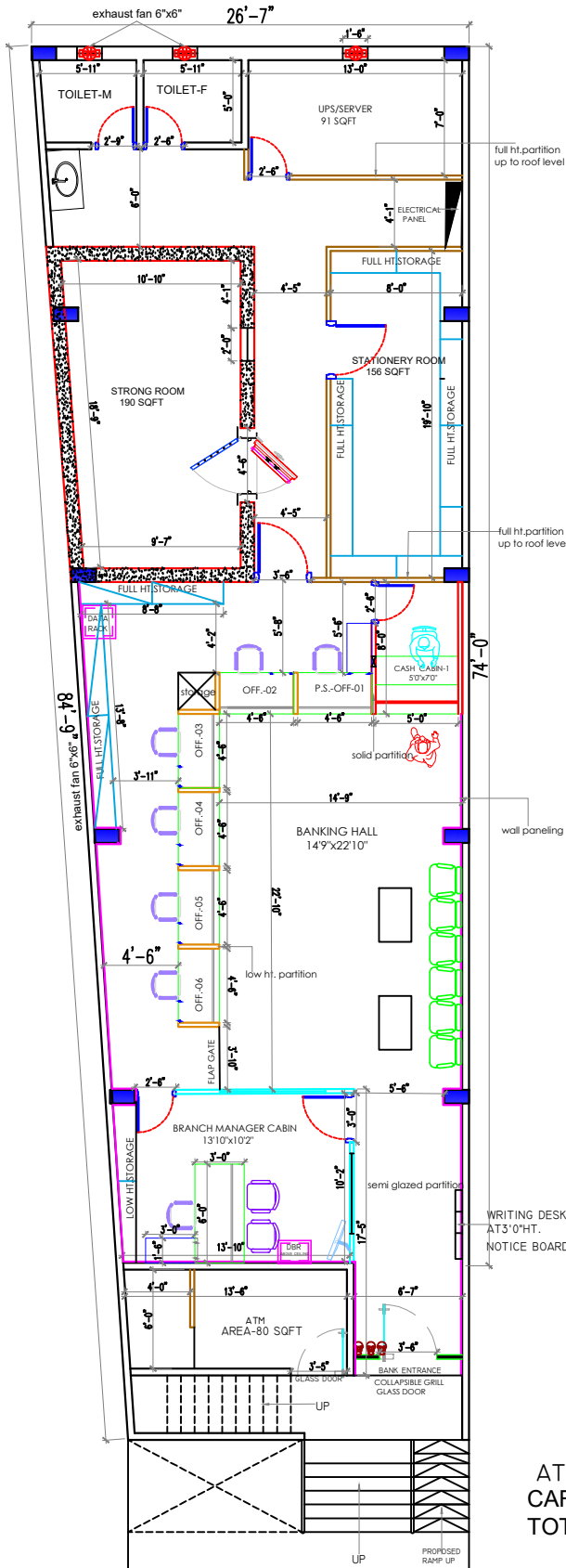
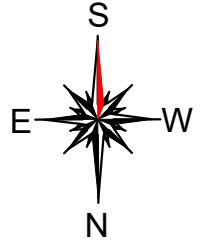

SUBMITTED FOR	
PRELIMINARY	<input type="radio"/> APPROVAL
PROPOSAL	<input checked="" type="radio"/> CONSTRUCTION

REVISIONS :

Suffix	Date	Initials	change

Client :

Architects : **ATTIK ARCHITECTS**
 architects
 IBS BUILDING, SITHLA ASTHAN ROAD, NEAR TILKAMANJHI
 THANA, BHAGALPUR, PH. NO. 7503821328
 9430546484, 9899677289
 BRANCH OFFICE- B. DEOGHAR, JHARKHAND

Consultants :

Job Title :
**PHUSRO BRANCH
 CANARA BANK, RANCHI
 ZONE**

Drawing Title :

Date 10-10-2024	Chkd. by: AR.VIKASH KUMAR	NORTH :
Scale NTS	DEALTY BY :	
DRG NO- 01		R 0

ATTIK ARCHITECTS
 This drawing/design is property of Attik architects. No part of this may be reproduced or implemented in any form without prior permission in writing from Architects. Any person doing so, shall be liable to criminal prosecution and civil claims for damages.

PHUSRO BRANCH

MAIN ROAD

**ATM AREA-80 SQFT
 CARPET AREA-1590 SQFT
 TOTAL CARPET AREA-1670 SQFT**