

SHARMA
PROPERTIES
(BRANCH BACK SIDE)

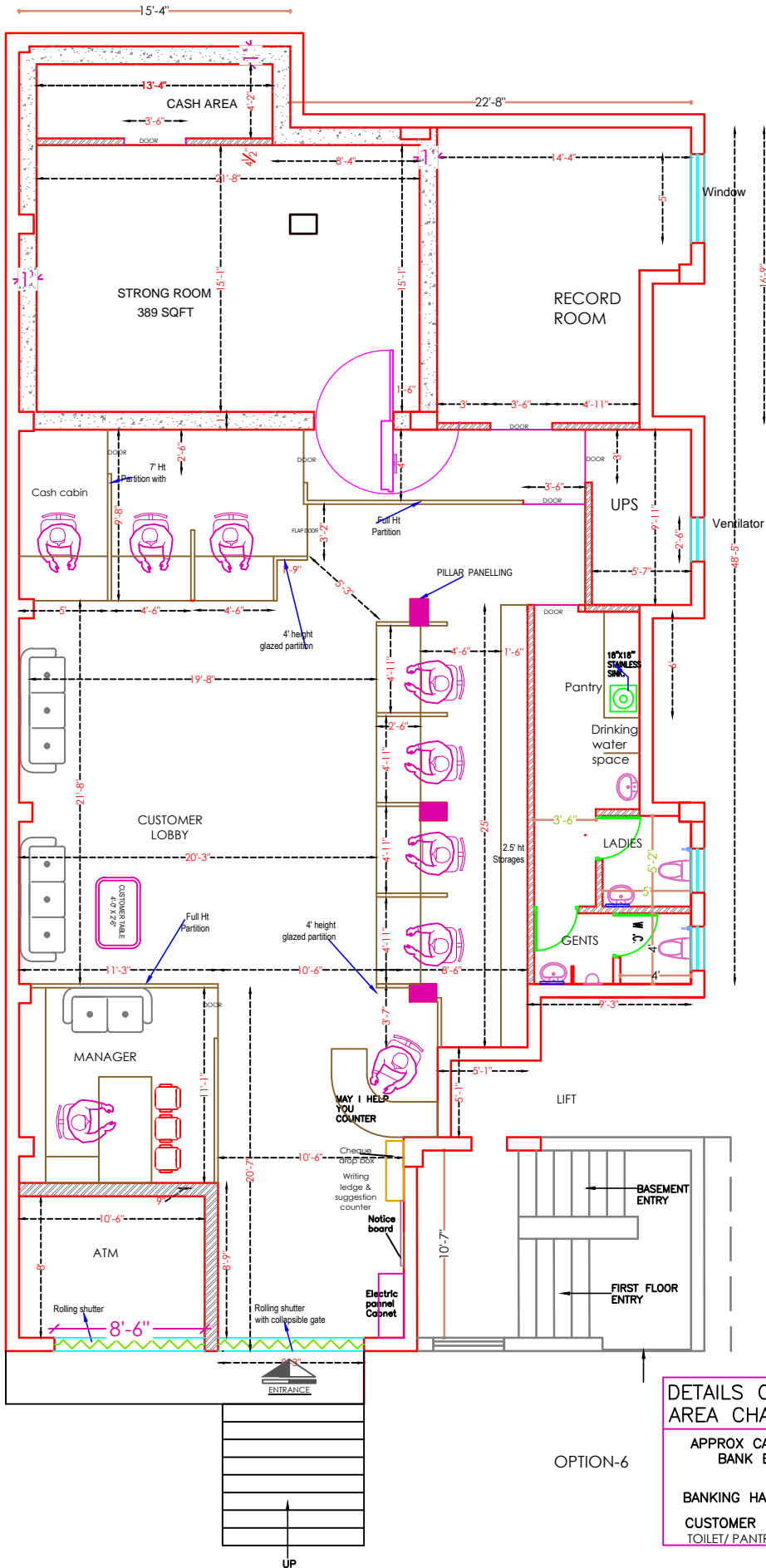

GUPTA
PROPERIE
(BRANCH RIGHT SIDE)

DETAILS OF PROPOSED AREA CHART	IN.SQFT
APPROX CARPET AREA FOR BANK BRANCH+ATM	2108.0
BANKING HALL AREA	1285.0
CUSTOMER AREA	676.0
TOILET/ PANTRY AREA	97.00

OPTION-6

PROJECT
PROPOSED FURNITURE LAYOUT FOR CANARA BANK BRANCH- AT
GF, PK-10 SECTOR 122 -NOIDA

DRAWING
LAYOUT



SCALE
N.T.S.
DATE
DEC. 2023

ARCHITECT
MOHIT & ASSOCIATES
ARCHITECTS, INTERIORS, ESTIMATORS.
L-355A VINEET KHAND, GOMTI NAGAR,
LUCKNOW, M.C. - 2262118992/7428217659