

Rear Margin

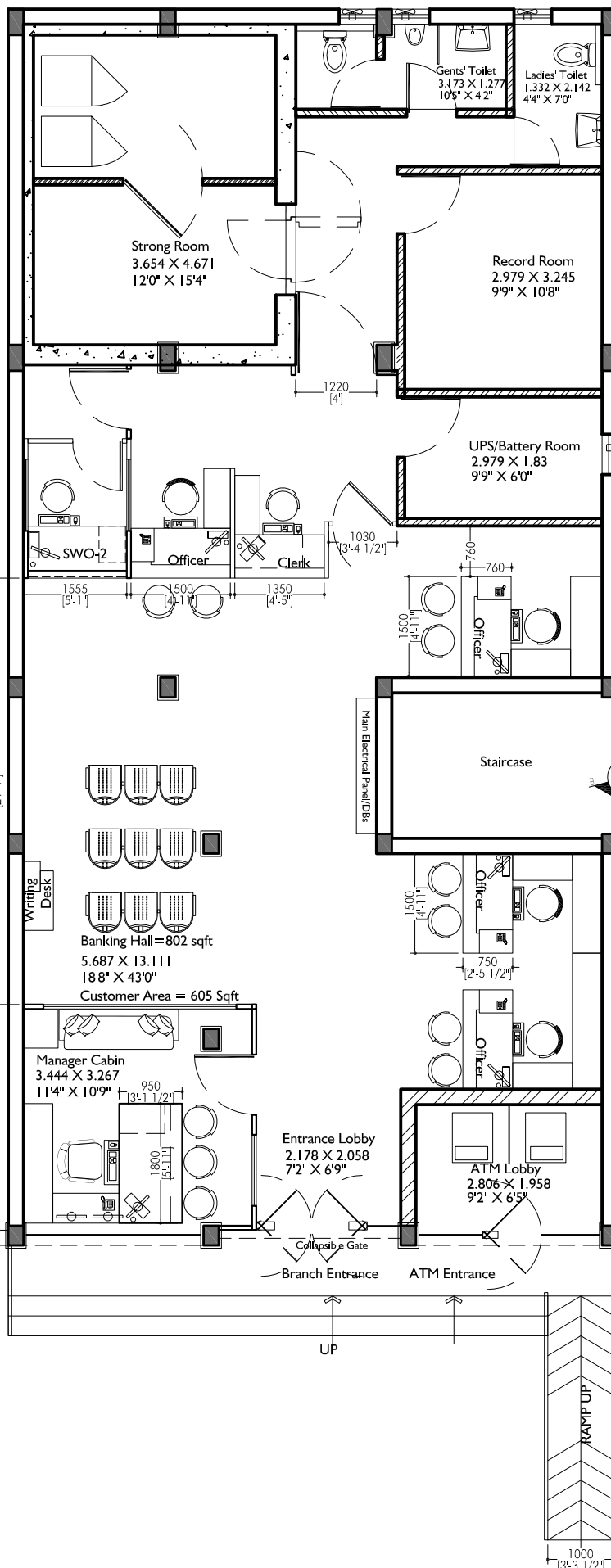

AREA	Area in sqft
TOTAL AREA	1610
AREA UNDER COLUMNS	2.22
AREA OF WALLS & TOILETS	153.68
CARPET AREA	1454



NOTE-

REVISIONS	NO	DATE	ISSUED TO	NO	DATE

PROJECT-
PROPOSED INTERIOR WORK OF PARDI BRANCH
FOR:
CANARA BANK R.O-1, NAGPUR

DWG TITLE- FURNITURE LAYOUT
Area = 1610 Sq.ft
DWG NO-
THE DRAWING IS THE PROPERTY OF S.NANDEKAR & ASSOCIATES. IT IS NOT TO BE COPIED, REPRODUCED, EITHER WHOLLY OR IN PART, OR BY ANY MEANS, WITHOUT THE WRITTEN PERMISSION OF THE ARCHITECTS. ANY SUCH VIOLATION WILL BE THE RESPONSIBILITY OF THE USER. ARCHITECTS/ENGINEERS/ASSOCIATES DO NOT TAKE ANY RESPONSIBILITY OF PRESENT OR FUTURE STATE OF THE STRUCTURE IN CASE OF ANY DISASTERS OR UNUSUAL OCCASIONS.

ARCHITECTS-
S.NANDEKAR & ASSOCIATES
103, UTKARSHA BHAWANG, Beside MOUNT CARMEL, AJINISQUARE, NAGPUR-46
TEL- 0712-2252945, FAX - 0712-2243921

Rev.-
Alt - 0 5
SCALE -
DATE- 09/01/24
Drawn By-