



NIT Ref. COHUB: P&E:DPJ:677: 2024-25 dated 09.07.2024
Notice Inviting Tender

FURNISHING WORKS IN EXISTING PREMISES OF KULGOD BRANCH (CHIKODI RO)

Location of the Branch/Office	Canara Bank, KULGOD Branch
Eligibility of the contractor	Eligible Furnishing Contractors Empanelled With Circle Office: Hubballi
EMD	Exempted for Contractors Empanelled With Circle Office: Hubballi
Address for submission of sealed tenders	Circle Office: Hubballi
Last date & time for submission of sealed tenders	18.07.2024 up to 3:30 pm
Date & Time of opening of sealed tenders	18.07.2024 up to 4:00 pm
Payment terms	As per IBA norms.
Time limit for execution of work	30 days from the date of work order
Defect liability period	12 months after completion of work
Retention money towards defect liability period	3 % of final bill amount
Date of commencement of work	As per work order
Income Tax &/ other taxes	At applicable rate
Payment	After the completion of the work, as per procedure
Period for submitting final bill by contractor	Within one month from the date of virtual completion of the work
Liquidated damage for non completion of work in time	1% OF THE TENDERED AMOUNT per week and part thereof for the delayed period maximum of 5%.
Rates quoted by bidder	<p>I. The quoted rate should be inclusive of Cost of materials, transport, loading , unloading charges, cost of installation, all taxes (excluding GST), wastages, machinery, temporary works such as scaffolding, cleaning, overheads, profit, statutory expenses, incidental charges and all related expenses required for the completion of the work.</p> <p>II. Additional claims other than the quoted amount will not be entertained.</p> <p>III. The quoted rates shall be firm throughout the completion of the project</p>
Insurance	Falls under scope of contractor.
Validity of submitted tender	90 days from the opening of tenders

The sealed tender must be dropped in tender box kept at the Circle Office within the above stipulated time. Tenderer / authorized representative are requested to be present at the time of opening. Canara Bank will not be bound to accept the lowest tender & reserves the right to reject any or all the tenders without assigning any reason thereof.

NIT Ref. COHUB: P&E:DPJ:677: 2024-25 dated 09.07.2024

To

The Assistant General Manager,
P & E Section,
Canara Bank Circle Office,
BAGALKOT - 580030.

Dear Sir,

Sub: Furnishing works in the premises of KULGOD Branch.

I/We hereby declare that I/ We have carefully gone through the conditions laid down in the Notice Inviting Tender, General notes, General Conditions of Contract, Special conditions, Schedule of approximate quantities and rates, Form of Agreement, General Specification, Approved manufacturers/natural source of materials Technical Specifications of schedule of quantities, and clearly understood all the same and on the basis of the same I/ We have quoted our rates in the Schedule of Quantities(i.e. BOQ) attached with the tender documents.

I / We have enclosed herewith a Demand Draft of _____Bank & No. _____ dated _____ favoring **Premises & Estate Section, Circle Office, Canara Bank, Hubballi** for ₹_____ payable at Hubballi, towards E.M.D.

In the event of this Tender being accepted I/ We agree to enter into the agreement and submit the declaration on requisite non-judicial stamp papers as and when required and execute the contract according to your form of Agreement etc., in default whereof, I/ We do hereby bind my-self / ourselves to forfeit the aforesaid deposit.

I / We further agree to complete the work included in the said schedule of quantities within specified time from the date of the work order issued to commence the same.

I / We agree to pay all taxes(except GST), insurance charges as prevailing from time to time, on such items for whom same is to be levied by/ for the government, and the rates quoted by me / us are inclusive of all the same.

Once again knowing full well the contents of this tender, I / We sign this tender on this _____Day of _____ month of 2023.

Signature of the Contractor with seal & date

SPECIAL CONDITIONS & INSTRUCTIONS FOR THE GUIDANCE OF TENDERER

1. The works at the branch/Office premises need to be executed duly taking care of the local bye laws/regulations of the local authorities like Police Dept, Water supply and Sanitary Board, Electricity Board, Central/ State Labor Commission etc. Necessary permissions, licenses, temporary connections if needed shall be obtained by the Contractor and Bank shall not be held responsible for any lapses.
2. The works shall be executed duly taking care of all safety measures and Bank shall be fully indemnified for any 3rd party claims, casualties, mishaps, loss of property etc. related to the undertaking & the execution of the subject work.
3. GST TAXES: As per the new Goods & Services Tax (GST) structure, the tenderer are required to have GSTIN number & Tenderer without GSTIN number are not eligible to participate in the tender process. The details as per the Annexure I attached are to be mandatorily furnished along with the tender. The eligible tenderer are requested to quote the GST separately. The taxes will be deducted at source as per the statutory requirements. While raising the bill, it shall be mentioned as bill to Canara Bank and our Bank's GSTIN number to be mentioned.
4. CANARA BANK'S KARNATAKA STATE GSTIN NUMBER is 29AAACC6106GIZX.
5. Tenderer are requested to submit the EMD in the form of crossed Demand draft only on any of the nationalized Banks/State Bank Drawn in favor of Premises & Estate Section, Circle Office, Canara Bank, BAGALKOT, payable at BAGALKOT. Tender with EMD in any other forms shall be rejected.
6. Tenderer are expected to visit the site before quoting the rates and should satisfy themselves as to the nature and conditions of work facilities available etc.
7. The tenderer are required to examine the enclosed general plan, tender form and conditions mentioned in the tender.
8. The tenderer should quote the rates in the figures. The amount for each item should be worked out and the requisite totals shall be given. The total amount shall be written both in figures and words.
9. The rates quoted in the tender shall be for measured finished works and shall include all changes including cost of materials, transportation, freight charges etc. complete.
10. The work is to be completed within stipulated time.
11. The successful tenderer shall give all necessary personal attention to the work during the process of work and also until the expiry date of "Defects Liability Periods" which is 12 months after the date of completion of the work.
12. The bank reserves the right to reject any portion of the work or material, which is, found unsatisfactory not up to the standard.

NIT Ref. COHUB: P&E:DPJ:677: 2024-25 dated 09.07.2024

13. A retention amount of 3% of the bill amount will be retained from the final bill and shall be paid to the successful tenderer after the defects liability period is over and upon the certification of the engineer.
14. Income tax deduction at prevailing / appropriate rates will be retained from each running bill which will be certified by the income tax authorities and a receipt will be given to the contractors.

CONDITIONS OF CONTRACT

1. If any additions and alterations are found necessary, the tenderer will have to do the same within the tendered rates with the prior approval of the bank.
2. The contractor shall employ adequate labor to complete the work within the scheduled time and shall make his own arrangements for housing his materials etc.
3. The contractor shall have to make his own arrangements to house his labor and staff for their services.
4. All tendered rates shall include for the cost of materials, labor, supervision, tools, plant, transportation, contingencies, duties, breakages, wastages, sundries, scaffolding, etc complete.
5. All instruction regarding the execution of the work shall be received from the officials through consultant/architect only. Any other instructions issued directly to the contractor by anyone else shall not be binding on the bank.
6. The bank shall have the power to omit or cancel any item of work without assigning any reason whatsoever and no claim for compensation for damage will be entertained for such omissions and cancellation.
7. The contractor shall maintain satisfactory progress of work as well as maintain a desired level of workmanship. If in the opinion of the bank the progress is unsatisfactory and / or the workmanship is unsatisfactory then the bank shall take possession of the work within 7 days to that effect. The bank shall then complete the entire work and rectify all the defects at the contractor's cost and consequences.
8. In case the bank is not satisfied with the quality of materials used by the contractors, they reserve the right to direct the contractor to procure such materials supplied from agencies they deem fit.
9. The contractor is to be responsible for clearing any, all dirt and rubbish and superfluous materials as they accumulate and everything unnecessary and to leave the premises in a clean and orderly condition on completion and fit for occupation. No extra payment shall be made for doing this.
10. Any work which is not approved by the bank shall have to be removed within 24 hours from the time of order and shall have to be redone by the contractor at his own cost and this cost will be borne by the contractor.
11. No deviation whatsoever for any reason will be permitted, however, if any deviation becomes necessary, the same should be brought to the immediate notice of the bank and written approval must be obtained for such deviation before proceeding with the execution of work.

NIT Ref. COHUB: P&E:DPJ:677: 2024-25 dated 09.07.2024

12. The bank has got the right to supply any materials required for the work and cost of materials so supplied will be deducted from the bills of the successful contractor.
13. The contractor shall be responsible for safe custody of his materials/materials issued to him by the bank till they are used for the work. He shall make his own arrangements for the safe custody and proper storage and preservation in sound condition till the same are actually used in the work.
14. The tenderer shall extended full co-operation to the other contractor /agencies like electrical, air conditioning, Fire & CCTV, LAN etc who are also working for the same project and co-ordinate with them in finishing the awarded work within the stipulated time given.
15. The contractor shall have a competent supervisor on the site for all the time.
16. For any new item the rate will be fixed by the bank as per prevailing fair market rate and labor which will be binding on the contractor.
17. In case the brand of materials mentioned in the tender is not available in the market, the alternate brand shall be used only after prior written approval of the bank.
18. The contractor shall be given a single electrical connection at work site. Electrical charges for consumption by the contractor will be charged separately by the bank, contractors have to provide sub-meter.
19. The successful tenderer shall not anticipate any financial help from the bank in the form of adhoc payment / advance for mobilizing and for starting the work.
20. The contractor should strictly adhere to the specifications and make of the materials, mentioned in the annexure. Any deviation will summarily reject the items of the work and not qualify for payment.
21. The successful tenderer shall be ready to carry out works between non banking hours and even at nights and holidays. The contractor should sign all the pages of the document and the same shall be submitted to us.

Acceptance of contractor for Labor laws

- The successful tenderer / Contractor shall carefully and diligently implement the provisions of the Contract Labor Act & Contract Labor Rules.
- The Bank shall be entitled to deduct from the Contract Consideration, any such amount which the Bank has to pay in accordance with the Contract Labor (Regulation & Abolition) Act 1971 and Workmen's Compensation Act, in the event of the Bank having to disburse compensation / effect any payment under the Contract Labor Acts / Rules.
- Please note that as per rule 81(1) of Contract Labor (R&A) Rules, 1971, it is mandatory on the part of the Contractor to the display the notice containing the following details at prominent place at the work site.
 - a) Rates of wages.
 - b) Hours of work.

Signature of Bidder with seal

Premises & Estate Section,
Circle Office Hubballi
Centrum Building,

Page 5 of 24



NIT Ref. COHUB: P&E:DPJ:677: 2024-25 dated 09.07.2024

- c) Wage periods.
- d) Dates of payment of wages.
- e) Names & addresses of the Labor Inspectors having jurisdiction &
- f) Date of payment of unpaid wages.

The notice containing the above details shall be displayed without fail at the work site.

1. The Contractor shall not engage any workmen for wages, less than the minimum wages prescribed under the notification issued by the Central Government.
2. The contractor should follow all labor laws/guidelines laid down by central /state government from time to time.
3. ABNORMALLY HIGH AND LOW RATED ITEMS :

For item rate tenders if, the rates quoted by the lowest bidder for certain items of the Bill of Quantities of the tender are found to be abnormally high or low in comparison to the market rate analysis of the item done by the Architects/Bank and or in comparison to Architect/Bank's method of working out market rate justification for the items, the same shall be governed as under in order to avoid financial loss to the Bank in the event of default of Bidders.

- i. For abnormally high rated items (AHR), the progressive payment shall be 80% (eighty percent) of the payment due to the Bidder against execution of the AHR item. The balance withheld 20% payment shall be released after 75% of total value of the original contract is complete in financial terms or this 20% withheld payment can be released to the Bidder on submission of an unconditional bank guarantee of equivalent amount in the proforma of Bank. Further deviation limit for AHR items shall be nil on plus side and Bank reserves the right to restrict, substitute or not execute the AHR items during execution. The decision of the Architect/Bank's Engineer in this regard shall be final and binding on the Bidder.
- ii. For abnormally low rated (ALR) items the Bidder shall submit Bank Guarantee of difference in total of amount of ALR item(s) and the total amount of corresponding items at market rate of the Architect/Bank. This bank guarantee shall be valid till completion of the project. In exceptional circumstances, the amount of Bank Guarantees (BG) may be reduced or BG released earlier than completion period if, in view of Architect/Bank's Engineer, all ALR items as provided in the contract are executed as per terms of contract and/or not required to be executed.

Notwithstanding what is contained in Para i) & ii) above, the provisions of Para (i) and (ii) shall not be applicable on tenders invited on percentage rate basis.

The decision of the Bank on identification/ marking of AHR and ALR item are final and binding on the Bidder. In case the Bidder do not agree for furnishing of Bank Guarantee as above towards ALR items, at the time of award of works, the EMD/Performance guarantee of the Bidder shall be forfeited and decision of Architect in this regard shall be final and binding on the Bidder.

CERTIFICATE

I / WE HAVE READ, FULLY UNDERSTOOD THE ABOVE MENTIONED REGULATIONS OF LABOUR LAWS/GUIDELINES AND ACCEPT THE SAME IN TOTO. I ALSO UNDERTAKE TO FOLLOW ALL LABOUR LAWS/GUIDELINES LAID DOWN BY CENTRAL /STATE GOVERNMENT FROM TIME TO TIME & INDEMNIFY THE BANK AUTHORITIES.

Signature of Bidder with seal

Premises & Estate Section,
Circle Office Hubballi
Centrum Building,

Page 6 of 24

ANNEXURE I (TO BE MANDATORILY FURNISHED)

1.	Name of the Contractor under the Contract Labor (Regulation and Abolition) Act, 1970 (37 of 1970) (if applicable)	
2.	LIN / PAN No	
3.	Email Id	
4.	Mobile No.	
5.	No. & date of Certificate of Registration/ License*	
6.	Name of Person in charge of work	
7.	LIN / PAN No. of the person in charge of work	
8.	Email Id of the person in charge of work	
9.	Mobile No. of the person in charge of work	

* Please strike off whichever is not applicable

APPROVED LIST OF MATERIALS

1	Wood: All wood must be well seasoned, free from knots, other defects, decay and defects due to handling and transportation. Wherever necessary provide with anti termite treatment.	Sal wood/ Thali wood (imported)
2	Teak Wood	Old Burma Teak
3	Marine grade plywood (BWF PF bounded)	ISI marked, complying to BIS specifications UNIPLY/ KITPLY/ CENTURY PLY/ ARCHID PLY
4	MR grade commercial plywood 4mm/6mm/12mm/ 19mm/25mm sizes.	ISI marked, complying to BIS specifications UNIPLY/ KITPLY/ CENTURY PLY/ ARCHID PLY
5	Veneers	Anchor/Green Ply / Century / Euro
6	Laminate: Design , shade, finish as per Architect's Selection confirming to IS: 2046	Decolote- formica/ Marino/ mica Greenlam / Meriono / Euro
7	Powder coated track, ceiling	Interarch, Vista - levotor, Luxalon
8	Hinges, tower bolts, handles	Brass oxidized/ epoxy powder coated (heavy duty)
9	Glass, Float Glass	Saint-Gobain / Modiguard / Asahi
10	Adhesive materials	Fevicol (pidilite make)
11	Powder coated aluminum partitions (15.20 micron two step electrical color process using polyester powder)	Jindal / Indal/ Hindal (Heavy Gauge 1.2 mm th, 15.20 micron 2 Step thick electrical color process Using polyester powder)
12	Pre laminated boards confirming to IS: 12823: 1990	Novopon /Eco board (Exterior grade only)
13	Floor springs confirming to IS: 6315/ door closure confirming to IS: 3564	OZONE/ HAFELE/EBCO
14	Fixtures	All hardware fittings & fixture are to be powder

ಸಿಂಡಿಕೇಟ್ ಸಿಂಡಿಕೇಟ್ Syndicate

NIT Ref. COHUB: P&E:DPJ:677: 2024-25 dated 09.07.2024

		coated. Color, finish as per Bank's specification, Godrej makes.
15	Melamine Polish	Asian Paint / ICI / Nerolac
16	External Emulsion (Anti-flaking, Anti-fungal)	Asian (Ace)/ Nerolac/ Berger/Dulux Sample to be approved by the Architect.
17	Oil Bound Distemper	Asian / Nerolac/Berger/Dulux Sample to be approved by the Architect.
18	Synthetic Enamel Paint	Asian /Nerolac/Berger/Dulux. Sample to be approved by the Architect.
19	Automobile Duco paint	MRF / ICI / Asian
20	Carpet Tiles	Nylon carpet tile –shaw/Milliken/Bentley prince
21	Cement	ACC, UltraTech, Ambuja – 43 grade
22	Bricks	Burnt bricks with minimum strength of 35KG/Cm ²
23	Hinges / drawers	Earl-Bihari Pvt Ltd, Godrej
24	Steel	HYSD bars with FE-415 grade
25	Vitrified tiles	Naveen / RAK / Nitco / Kajaria
26	Ceramic Tiles	H & R Johnson/Bell/Kajaria/Naveen /Spartek.
27	Glazed Tiles	H & R Johnson/Bell/Kajaria /Spartek/ Naveen
28	Tiles fixing adhesive	Algitile / Balgrout.
29	False Ceiling tiles	Armstrong or equivalent only
30	Italian Marble	Classic / Nitco / Elegance
31	Vertical / roller blinds	Hunter Douglas, Mac, Vista, Technifab
32	Wall paper	Marshall / ego / softek
33	Glass film	GARWARE OR EQUIVALENT
34	Drawers / cupboards Locks	Godrej / Yale / Haffele / Dorma Laxmi Make
35	Door Locks	SS finished Mortise lock of Laxmi make
36	PVC Pipes	Finolex /Prince
37	M.S.Pipes	Tata
38	Sanitary Ware	Parry ware /Hindustan sanitary
39	Granite slab 20 mm thick	Edges shall be rounded. Beveled.
40	Vinyl flooring (2mm thick)	Royal House
41	Door closure	Everite/ Godrej/ Hafele
42	Steel	Kamadhenu

Note: Samples are to be approved by Bank and Architect if any. Any brands indicated under the items specifications in the Bill of quantities will prevail over the above indicated makes.

Signature of Bidder with seal

Premises & Estate Section,
Circle Office Hubballi
Centrum Building,

Page 8 of 24

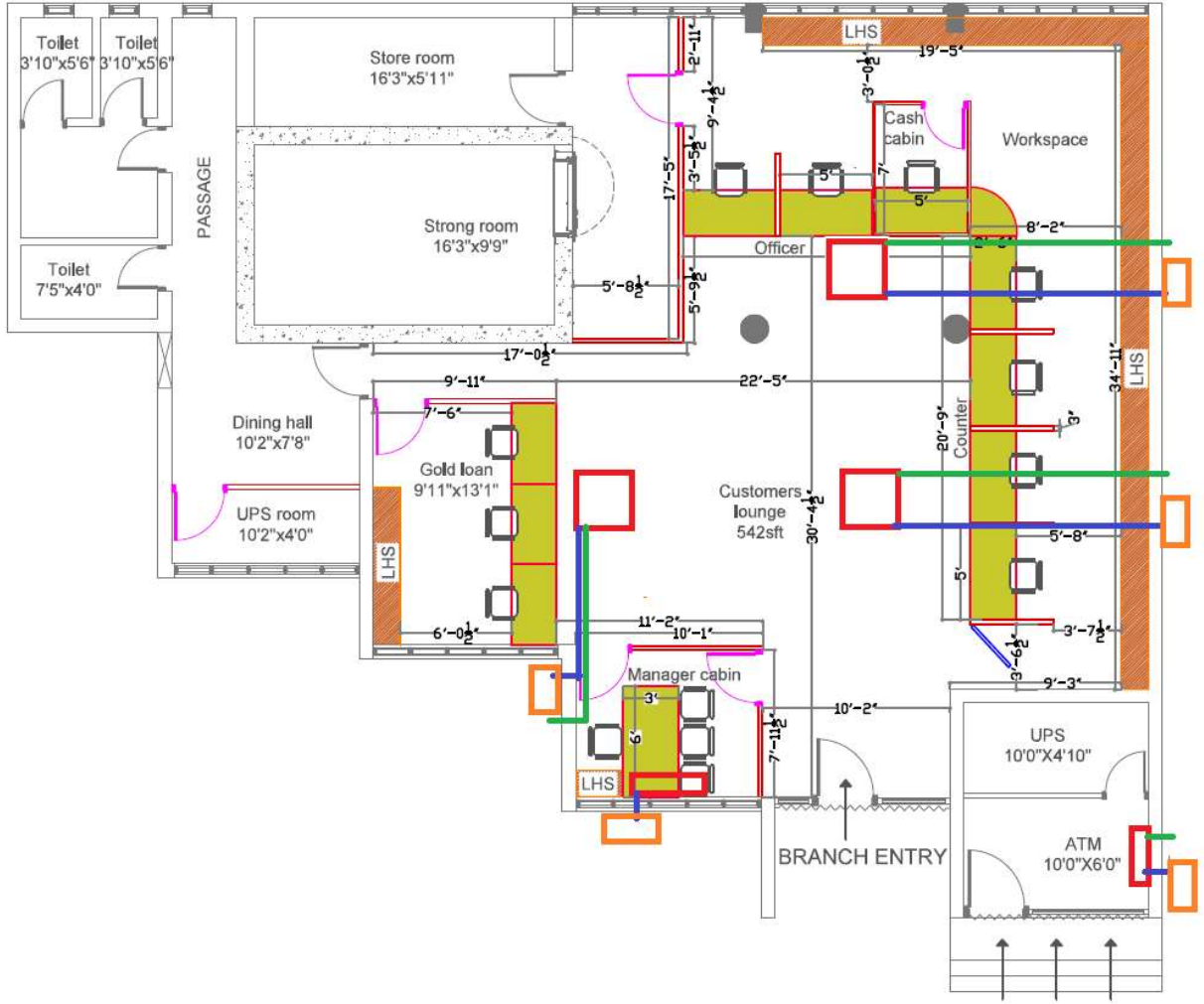

S.No	DESCRIPTION OF ITEM	QTY	UNIT	RATE in Rs	AMOUNT in Rs
1.00	BRANCH ENTRANCE PARTITION WITH DOOR				
a	Providing and fixing of partly glazed double skin partition using 50mmx50mm Aluminium sections of thickness 1.0mm with Four verticals and five horizontals at 0', 3', 7', false ceiling & true ceiling level. The partition shall be covered by 6mm thick MR grade commercial plywood on both sides for the bottom, top panels. All the openings and exposed aluminium faces shall be covered by 19mm thick MR grade commercial ply wood for fixing glass and beadings. The finishing shall be with 1mm thick lamination of approved shade on both sides. The middle panel shall be covered by 8mm thick plain glass with 8mm thick beech wood beadings projecting 3mm beyond the frame work . Necessary openings for the door shall be provided with 50mmx 12 mm beech wood beadings. All the exposed wood / woden beadings shall be neatly finished with 2 coats of wood polish & stained to required colour.				
b	The partition shall have 2 door shutters of size 7' X 3' fixed in the opening of partition under (a) above using 30mm water proof flush door shutter of approved make with alround beach wood beeding and covered by 6 mm thick MR grade commercial ply wood on both sides. An opening of 24"x66" shall provided in each shutter and the same shall be covered by covered by 8mm thick plain glass with 8mm thick beech wood beadings projecting 3mm beyond the shutter surface . The shutters shall be hung on the top by metal pivot and bottom by heavy duty floor spring of approved make . Each shutter shall be provided with 2 Nos 1'3" STEEL TUBULAR handles ' H ' shapped and 230mm brass tower bolts. All the exposed wood / woden beadings shall be neatly finished with 2 coats of wood polish & stained to required colour.				
c	All the glass surfaces shall covered on one side as per the design by frosted film of approved make.				
	The lamination shall be provided upto the false ceiling level. payable area shall be for the frame work including the doors and door openings . The rate for the above (a+b+c) items ALL AS PER ARCHITECT DIRECTION	80	Sft		
2.00	ALUMINUM FRAMED PARTLY GLAZED PARTITION (MANAGER CABINS)				
	Providing and fixing of double skin partition using 50mmx50mm Aluminium sections of thickness 1.5mm with verticals at a maximum spacing of 2 ft. C/C and five horizontals at 0', 2', 7', false ceiling &	148	Sft		

NIT Ref. COHUB: P&E:DPJ:677: 2024-25 dated 09.07.2024

	<p>true ceiling level.The corner verticals shall be common.The partition shall be covered by 6mm thick MR grade commercial plywood on both sides for the bottom and the top panel.The middle panel to be covered by 8mm thick plain glass fixed with 8mm thick beech wood beadings of necessary width. All the openings and exposed aluminium faces shall be covered by 19mm thick MR grade commercial ply wood for fixing glass and beadings. All the accessories used shall be of concealed type.The finishing for plywood shall be with 1mm thick lamination of approved shade on both sides. There shall be 4" height skirting in the top and bottom on both sides with 1mm lamination finish. Necessary openings for the door shall be provided which shall be finished with beach wood beadings. All the exposed wood / wooden beadings shall be neatly finished with 2 coats of wood polish & stained to required colour. All the glass surfaces shall covered on one side as per the design by frosted film of approved make. The lamination shall be provided upto the false ceiling level. payable area shall be for the frame work excluding the door openings .</p>				
3.00	FULLY PANELLED PARTITION W/ LAMINATION ON ONE SIDE				
	<p>Providing and fixing double skin partition using 50mmx50mm Aluminium sections of thickness 1.5mm with verticals at a maximum spacing of 2 ft. c/c in both directions.The corner verticals shall be common.The partition shall be covered by 6mm MR grade commercial thick plywood on one side and 8mm thick cement bonded particle board on the other side . The finishing shall be with 1mm thick lamination of approved shade on ply wood side and 2 coats of plastic emulsion painting on cement board, with putty wherever necessary. All the exposed wood / wooden beadings shall be neatly finished with 2 coats of wood polish & stained to required colour.There shall be a 4" height skirting in the top and bottom on lamination finish side .Necessary openings for the door shall be provided which shall be finished with beach wood beadings.The lamination shall be provided upto the false ceiling level. payable area shall be for the frame work excluding the door openings.</p>	NIL			
4.00	FULLY PANELLED PARTITION and Partition in Strong Room				
	<p>Providing and fixing double skin partition using 50mmx50mm Aluminium sections of thickness 1.5mm with verticals at a maximum spacing of 2 ft. c/c in both directions.The corner verticals shall be common.The partition shall be covered by 6mm MR</p>	360	Sft		

Signature of Bidder with seal

Premises & Estate Section,
Circle Office Hubballi
Centrum Building,

Page 11 of 24

NIT Ref. COHUB: P&E:DPJ:677: 2024-25 dated 09.07.2024

	grade commercial thick plywood on both sides and finished with 1mm thick lamination of approved shade. All the exposed wood / woden beadings shall be neatly finished with 2 coats of wood polish & stained to required colour. There shall be a 4" height skirting in the top and bottom on lamination finish side .Necessary openings for the door shall be provided which shall be finished with beach wood beadings. The lamination shall be provided upto the false ceiling level. payable area shall be for the frame work excluding the door openings.				
5.00	DOOR FOR PARTITIONS - PARTLY GLAZED				
	Providing and fixing door of size 3' X 7' (W X H) using 30mm thick water proof flush door shutters with alround beach wood beedding. An opening of 24"x 40" shall be provided. The door shall be finished with 1mm thick lamination of approved shade except for the opening. The opening shall be covered by 8mm thick plain glass fixed with necessary beech wood beadings. All the exposed wood / wooden beadings shall be neatly finished with 2 coats of wood polish & stained to required colour. All the glass surfaces shall covered on one side as per the design by frosted film of approved make. All the accessories used shall be of concealed type. There shall be 4" height skirting in the bottom with 1mm lamination finish of approved shade . Each door to be fixed to the partition using 5" length stainless steel hinges - 3 Nos and provided with 1 No.of mortice lock, 2 Nos SS tubular handles, 1 No door closure and door stopper.	6	Nos		
	Providing and fixing door of size 2'6" X 7' (W X H) using 30mm thick water proof flush door shutters with alround beach wood beedding. An opening of 24"x 40" shall be provided. The door shall be finished with 1mm thick lamination of approved shade except for the opening. The opening shall be covered by 8mm thick plain glass fixed with necessary beech wood beadings. All the exposed wood / wooden beadings shall be neatly finished with 2 coats of wood polish & stained to required colour. All the glass surfaces shall covered on one side as per the design by frosted film of approved make. All the accessories used shall be of concealed type. There shall be 4" height skirting in the bottom with 1mm lamination finish of approved shade . Each door to be fixed to the partition using 5" length stainless steel hinges - 3 Nos and provided with 1 No.of mortice lock, 2 Nos SS tubular handles, 1 No door closure and door stopper.				
6.00	CASH CABIN FRONT & COUNTER TOP PARTITION				

Signature of Bidder with seal

Page 12 of 24

Premises & Estate Section,
Circle Office Hubballi
Centrum Building,

T: 08362-2239432/433 /434

Gokul Road, Hubballi-580030

E:pecohub@canarabank.com

ಸಿಂಡಿಕೇಟ್ ಸಿಂಡಿಕೇಟ್ Syndicate

NIT Ref. COHUB: P&E:DPJ:677: 2024-25 dated 09.07.2024

	Providing and fixing partition for cash cabin front by using 50mmx50mm Aluminium sections of thickness 1.5mm for the frame work. There shall be atleast three horizontals at 0'0", 0'8" and 3'6" levels [approx] from the customer counter top level (which will be at 3'6" height from floor level) and two verticals at the ends. The corner verticals shall be common. The exposed sections shall be covered by 6mm thick MR grade commercial grade plywood & finished with 1mm thick lamination of approved shade. The bottom 0'8" height panel to be covered by 7.5 mm thick 56mm x 47mm opening aluminium grill (AL 101) fixed with suitable beach wood corner beadings. At the mid portion of the panel there shall be an opening of 6" x 6" with alround frame work & this opening shall have a sliding or openable type shutter with locking arrangement from inside to facilitate cash receiving/ paying. The top panel shall be covered by two glass panels made of 12 mm thick plain glass fixed with 8mm thick beech wood beadings of necessary width with an intermediate horizontal gap between two glass panels to facilitate communication between custmer and cashier. All the glass surfaces shall covered on one side as per the design by frosted film of approved make. All the exposed wooden beadings shall be neatly finished with 2 coats of wood polish & stained to required colour.	40	SFT		
7.00	CASH CABIN SIDE & REAR PARTITION				
	Providing and fixing partitions for cash cabin sides & rear areas by using 50mmx50mm Aluminium sections of thickness 1.5mm for the frame work. The verticals spaced at required intervals but not more than 3 feet c/c unless otherwise specified. The corner verticals shall be common. There shall be atleast 4 horizontal sections at 0" 0', 2'0", 3'6" and 7'0" levels [approx] from the floor level. The bottom 3'6" height panel to be covered by 6mm thick MR grade commercial plywood on both sides and finished with 1mm thick lamination of approved colour. All the the glass openings & exposed surface of aluminium sections shall be covered by 19mm thick MR grade commercial grade plywood & finished with 1mm thick lamination of approved shade. The top panel shall be covered by 6mm thick plain glass panels in heights of 250mm with 50mm high slits and fixed with 8mm thick beech wood beadings of necessary width. All the glass surfaces shall covered on one side as per the design by frosted film of approved make. All the exposed wooden beadings shall be neatly finished with 2 coats of wood polish & stained to required colour.	115.7	SFT		

Signature of Bidder with seal

Premises & Estate Section,
Circle Office Hubballi
Centrum Building,

Page 13 of 24

ಸಿಂಡಿಕೇಟ್ ಸಿಂಡಿಕೇಟ್ Syndicate

NIT Ref. COHUB: P&E:DPJ:677: 2024-25 dated 09.07.2024

	There shall be a horizontal tray at 3 ft level to facilitate slips movement and communication between supervisor and cashier.				
8.00	Cash Counting Partition				
	Providing and fixing partitions for cash cabin sides & rear areas by using 50mmx50mm Aluminium sections of thickness 1.5mm for the frame work. The verticals spaced at required intervals but not more than 3 feet c/c unless otherwise specified. The corner verticals shall be common. There shall be atleast 4 horizontal sections at 0" 0', 2'0", 3'6" and 7'0" levels [approx] from the floor level. The bottom 3'6" height panel to be covered by 6mm thick MR grade commercial plywood on both sides and finished with 1mm thick lamination of approved colour. All the the glass openings & exposed surface of aluminium sections shall be covered by 19mm thick MR grade commercial grade plywood & finished with 1mm thick lamination of approved shade. The top panel shall be covered by 6mm thick plain glass panels in heights of 250mm with 50mm high slits and fixed with 8mm thick beech wood beadings of necessary width. All the glass surfaces shall covered on one side as per the design by frosted film of approved make. All the exposed wooden beadings shall be neatly finished with 2 coats of wood polish & stained to required colour. There shall be a horizontal tray at 3 ft level to facilitate slips movement and communication between supervisor and cashier.	80	Sft		
9.00	DOOR FOR BULK CASH CABIN - PARTLY GLAZED				
	Providing and fixing door of size 2'6" X 7' (W X H) using 30mm thick water proof flush door shutters with alround beach wood beading. An opening of 18"x 40" shall be provided. The door shall be finished with 1mm thick lamination of approved shade except for the opening. The opening shall be covered by 8mm thick plain glass fixed with necessary beech wood beadings. All the exposed wood / wooden beadings shall be neatly finished with 2 coats of wood polish & stained to required colour. All the glass surfaces shall covered on one side as per the design by frosted film of approved make. All the accessories used shall be of concealed type. There shall be 4" height skirting in the bottom with 1mm lamination finish. The door shutter shall be fixed with 3 nos stainless steel (SS) make 5" size hinges, one number 6 levered Godrej make (with minimum 3 keys) automatic NIGHT LATCH fixed just below 3 feet level and one 3" long SS material tower bolt and 4" long SS material handles on both the sides.	2	No		

Signature of Bidder with seal

Premises & Estate Section,
Circle Office Hubballi
Centrum Building,

Page 14 of 24

NIT Ref. COHUB: P&E:DPJ:677: 2024-25 dated 09.07.2024

10.00	ALUMINIUM GRILL FOR BULK CASH COUNTER TOP				
	Providing & fixing 7.5mm thick 48mm X 48mm opening white colour powder coated aluminium grill (AL 101) at the top of the cash cabin fixed with 8mm thick beech wood beadings of necessary width. All the exposed wood / wooden beadings shall be neatly finished with 2 coats of wood polish & stained to required colour. All the accessories used shall be concealed type. All the aluminium sections shall be white colour powder coated.	40	Sft		
11.00	ALUMINIUM FRAMED PARTLY GLAZED LOW HEIGHT PARTITION (SWS, CUBICLES..)				
	Providing and fixing of double skin partition using 50mmx50mm Aluminium sections of thickness 1.5mm for frame works with verticals at a maximum spacing of 2'6" C/C and three horizontals at 0', 2', 3'. The bottom panel upto 3' height shall be covered by 6mm thick MR grade commercial plywood on both sides with removable panel between 2' to 3' ft levels for conduits /wires. The top 2ft panel to be covered by 8mm thick plain glass with exposed top edge and fixed with 8mm thick beech wood beadings of necessary width. The top side of the glass shall be exposed with edges smoothly grided & polished. All the Glass openings & exposed surface of a sections shall be covered by 19mm thick MR grade commercial grade plywood & finished with 1mm thick lamination of approved colour. All the accessories used shall be of concealed type. There shall be 4" height skirting in the bottom on both sides with 1mm lamination finish. All the exposed wood / wooden beadings shall be neatly finished with 2 coats of wood polish & stained to required colour. All the glass surfaces shall covered on one side as per the design by frosted film of approved make. Necessary Holes must be made in the frame sections to run the wires, computer cables wherever necessary. Similarly necessary cuttings to be made in the partition to fix switch boxes of electrical, telephone sockets, computer Information outlets etc.	73	Sft		
12.00	RUNNING LOW COUNTER				
	The counter shall be of length 60", height 36", working top width of 30",customer top width of 6" with front panel, side vertical support, intermediate support using 19mm thick BWP block board. There shall be two draws of size 13" X 22" X 6" (internal dimensions) and cupboard with shutter at bottom on the right hand side of the counter fixed in between the intermediate support and				

Signature of Bidder with seal

Page 15 of 24

Premises & Estate Section,
Circle Office Hubballi
Centrum Building,

T: 08362-2239432/433 /434

Gokul Road, Hubballi-580030

E:pecohub@canarabank.com

NIT Ref. COHUB: P&E:DPJ:677: 2024-25 dated 09.07.2024

	main support.The draw shall be made of 19mm thick BWP block board for all the sides and 6mm MR grade commercial plywood for the botton. The drawers to be provided with metal channels with rollers of approved make for easy push and pull. draw bottom Partitions for denomination to be provided using 10mm plywood in first drawer. The working top,customer top, front panel, front face of shutter and draws shall be finished with 1mm thick lamination of approved shade. The front elevation of the counter shall be using 6mm thick MDF to provide recession and finished with Beach wood beadings, 1mm laminate finish.The customer top & working top shall be provided with 10mm thick plain glass with edges bivelled & polished. There shall be shelf of size 10" X 20" below the working top on left hand side for CPU UNIT using 19mm thick BWP block board. A foot rest of size 3" X 1 ½" hardaluminium section shall be provided. All the exposed edges shall be provided with beach wood beadings of size 19mm x 6 mm and finished with wood polish. All non-laminated exposed surfaces except beedings shall be provided with two coats of enamel paint over a coat of primer. Each draw shall have one multipurpose concealed lock, stainless steel handle and SS hinges for the shutter. Necessary openings for the access of the wires and plugs with wire manager to be provided with PVC caps for the counter top at appropriate location.	46	Rft		
13.00	Fire Proof Partition for UPS Room				
	Providing and fixing double skin partition using 50mm x 50mm (dimensions) aluminium sections of JINDAL/ INDAL make for frame works with verticals at a maximum spacing of 2 ft. c/c in both directions. The corner verticals shall be common. The partition shall be covered by 12 mm Bison Board on both sides. The finishing shall be with 1mm thick lamination of approved shade on both sides. There shall be a 4" height skirting in the top and bottom on both sides with 1mm lamination finish. All the exposed wood / woden beadings shall be neatly finished with 2 coats of wood polish & stained to required colour.Necessary openings for the door shall be provided which shall be finished with beach wood beadings.The lamination shall be provided upto the false ceiling level. payable area shall be for the frame work excluding the door openings .	200			
14.00	FRONT GLASS FOR Running COUNTER				
	Providing and fixing 12mm thick plain glass of height varying between 1' 6" & 1' 0" for the	70	Sft		

Signature of Bidder with seal

Premises & Estate Section,
Circle Office Hubballi
Centrum Building,

Page 16 of 24

NIT Ref. COHUB: P&E:DPJ:677: 2024-25 dated 09.07.2024

	front of the single window counters above the customer top. The vertical supports shall be from the main side partition and fixed with 8mm thick beech wood beadings of necessary width. A opening of size 5" X 5" is to be provided in the 1'6" glass above the customer top for cash / slip transaction with necessary lockable glass shutter . There shall be 2"/3" gap between the glasses counter top for easy communication with the customer. The exposed edges of the glass shall be bivelled, grinded and machine finished to render smooth edges. All the exposed wood / woden beadings shall be neatly finished with 2 coats of wood polish & stained to required colour. All the glass surfaces shall covered on one side as per the design by frosted film of approved make.				
15.00	LAMINATED FLUSH DOOR/WICKED GATE				
	Providing and fixing of wood framed door of size 3'6" x 2'6" wide using 30mm thick water proof flush door shutters with alround beach wood beeding. The Door shutter shall be finished with 1mm laminate of approved shade on both sides.The edges of the shutter shall be lipped with 6mm thick Teak / beach wood beedings. All the exposed wood / wooden beadings shall be neatly finished with 2 coats of wood polish & stained to required colour.The door shutter shall be fixed with 3 nos stainless steel (SS) make 5" size hinges, one number 6 levered Godrej make (with minimum 3 keys) automatic NIGHT LATCH fixed just below 3 feet level and one 3" long SS material tower bolt and 4" long SS material handles on both the sides. All the exposed wood shall be neatly finished with 2 coats of polish & stained to required colour.	1	Nos		
16.00	BULK CASH COUNTER WITH GLASS TOP				
	Providing and fixing Bulk cash counter of following specifications :				
	The counter shall be of length 72", height 42", working top width of 30",customer top width of 12" with front panel, side vertical support, intermediate support using 19mm thick MR PLY. There shall be two draws of size 15" X 22" X 6" (internal dimensions) and cupboard with shutter at bottom on the right hand side of the counter fixed in between the intermediate support and main support.The draw shall be made of 19mm thick BWP block board for all the sides and 6mm MR grade commercial plywood for the botton. The drawers to be provided with metal channels with rollers of approved make for easy push and pull. draw bottom Partitions for denomination to be provided using 10mm plywood in first drawer. The working				

Signature of Bidder with seal

Premises & Estate Section,
Circle Office Hubballi
Centrum Building,

Page 17 of 24

ಸಿಂಡಿಕೇಟ್ ಸಿಂಡಿಕೇಟ್ Syndicate

NIT Ref. COHUB: P&E:DPJ:677: 2024-25 dated 09.07.2024

	top,customer top, front panel, front face of shutter and draws shall be finished with 1mm thick lamination of approved shade. The front elevation of the counter shall be using 6mm thick MDF to provide recession and finished with Beach wood beadings, 1mm laminate finish.				
	The customer top & working top shall be provided with 10mm thick plain glass with edges bivelled & polished. There shall be shelf of size 10" X 20" below the working top on left hand side for CPU UNIT using 19mm thick MR PLY. A foot rest of size 3" X 1 ½" hardaluminium section shall be provided. All the exposed edges shall be provided with beach wood beadings of size 19mm x 6 mm and finished with wood polish. All non-laminated exposed surfaces except beedings shall be provided with two coats of enamel paint over a coat of primer. Each draw shall have one multipurpose concealed lock, stainless steel handle and SS hinges for the shutter. Necessary openings for the access of the wires and plugs with wire manager to be provided with PVC caps for the counter top at appropriate location.	1	No		
17.00	TABLES WITH GLASS TOP				
	Providing and fixing Tables of following sizes with front, working top and side vertical support, intermediate vertical support . There shall be three draws of size 15" X 22" X 5" fixed in alround boxing with top, side vertical, intermediate supports of the table as common side & top. The table & draws shall be made by all by using 19mm thick BWP block boardexcept for the draw bottom which shall be with 6mm MR grade commercual ply wood. The draw shall be fixed with metal channels with rollers of for easy push and pull.The front elevation of the table shall be as per the design using 6mm thick MDF to provide recession and finished with beach beadings.The working top, sides, front, front face of draw shall be finished with 1mm thick lamination. The working top shall be provided with 10mm thick clear glass with edges bivelled and machine finished to render smooth edges. Each draw shall have stainless steel handle with individual locks .				
	There shall be shelf of size 10" X 20" below the working top for the CPU UNIT using 19mm thick MR grade block board. A foot rest of 3" X 1 1/2" hardaluminium section shall be provided. All the exposed edges shall be provided with beach wood beadings of size 19mm x 6 mm and finished with wood polish. All non-laminated exposed surfaces except beedings shall be provided with two coats of enamel paint over a coat of primer. Each draw				

Signature of Bidder with seal

Page 18 of 24

Premises & Estate Section,
Circle Office Hubballi
Centrum Building,

T: 08362-2239432/433 /434

Gokul Road, Hubballi-580030

E:pecohub@canarabank.com

ಸಿಂಡಿಕೇಟ್ ಸಿಂಡಿಕೇಟ್ Syndicate

NIT Ref. COHUB: P&E:DPJ:677: 2024-25 dated 09.07.2024

	shall have one multipurpose concealed lock, stainless steel handle and SS hinges for the shutter. Necessary openings for the access of the wires and plugs with wire manager to be provided with PVC caps for the counter top at appropriate location.				
a	Manager Table of 3' 0" (W) x 6' 0" (L) x 2' 6" (H)0	1	No		
18.00	SIDE CUPBOARD				
	Providing and supplying SIDE cupboard of size 3' 0"(L) X 2' 6" (H) X 1' 6" (W) with top, sides, bottom, draws and front swinging shutters all by using 19mm BWP block board except for the rear portion & draw bottom which shall be covered by 6mm MR grade commercial plywood. There shall be two draws of size 17" X 16" X 5" (all internal dimension). The front, side, rear & top shall be finished with 1mm lamination. The draws shall have sliding arrangement using metal channels with rollers for easy push and pull. There shall be skirting of height 3". All the exposed edges shall be provided with beach wood beadings of size 19mm x 6 mm and finished with wood polish. All non-laminated exposed surfaces except beadings shall be provided with two coats of enamel paint over a coat of primer. The swinging shutters shall be fixed using SS hinges. There shall be 4 no.s of SS handles, 3 no.s multipurpose concealed for the entire unit. Any minor variation in the size shall be payable on proportionate volumetric basis.				
	Low Height Storage	184	Sft		
	Side Storage of 3'6""(L) x 2'6" (H) x 1'6" (W)	10	sft		
19.00	RUNNING STORAGE CUPBOARDS (SWING SHUTTERS)				
	Providing and supplying running storage cupboards of width 18" and height 36" or upto the specified height as per site conditions with top, sides, verticals at every 3ft C/C, horizontal shelves at 1.5 ft C/C or part thereof. The storage unit's verticals, horizontals & front swing shutters all shall be made by using 19mm BWP block board and only rear side covered by 6 mm Mr grade commercial ply wood. The front shutters may be of size 18" to 21" width. There shall be skirting of height 2" to 3". All the visible surfaces like front, top and sides shall be finished with 1mm thick lamination. All the exposed edges shall be provided with beach wood beadings of size 19mm x 6 mm and finished with wood polish. All non-laminated exposed surfaces except beadings shall be provided with two coats of enamel paint over a coat of primer. There shall be one number of multi-purpose lock for every two shutters. Each shutter shall have a stainless				

Signature of Bidder with seal

Premises & Estate Section,
Circle Office Hubballi
Centrum Building,

Page 19 of 24

ಸಿಂಡಿಕೇಟ್ ಸಿಂಡಿಕೇಟ್ Syndicate

NIT Ref. COHUB: P&E:DPJ:677: 2024-25 dated 09.07.2024

	steel handle, a brass ball catch/ aluminium powder tower bolt 3" size as the case may be. The payment shall be based on the elevation area of storage units .				
20.00	ALUMINIUM FRAMED FULL HEIGHT WALL/COLUMN PANELLING				
	Providing & fixing wall panelling using 50mmx 25mm Aluminium sections of thickness 1.5mm sections for the frame work spaced at 2 ft C/C and clad with 8mm thick MR grade commercial plywood and finished with 1mm thick lamination finish of approved shade. The soffits of the windows shall also be covered with panelling.(Wall panelling shall not be provided behind storages)	296	Sft		
21.00	MINERAL FIBRE BOARD GRID TYPE FALSE CEILING				
	Providing, fabricating, erecting lay-in type tegular/ drop type Mineral fibre board false Ceiling of 600mm x 600mm grid as per the following specifications.The approved brands are ARMSTRONG/ NITTOBO / SAINT GOBAIN. The following specifications are the minimum and tenderers may quote for the equivalent or better specification.	844	Sft		
	The grid system having 600mm x 600 mm or part thereof wherever necessary, shall be made using hot dipped galvanized steel section, exposed surface chemically cleaned capping prefinished in backed polyester paint, main Tee of size 14 x 38 x 0.33mm at every 1200mm c/c max and rotary stitched cross tee of size 14 x 38 x 0.33mm at every 600mm c/c and cross Tee of size 14x 38 x 0.33mm at every 1200 c/c max and 14 x 22 x 0.457mm wall angle alround the wall to form grid size of 600 x 600mm. The suspension system shall have 4mm dia pre-straightened GI rods which are in-turn supported from real ceiling using 6mm size anchor bolts, connected with adjustable Hanger clips/ J bolts and other accessories as per the manufacturers specifications. The T Sections have a Galvanizing of 120 grams per M2 & passed through for 500 hrs of Salt test.				
	The tiles/ panels shall be of prima Fine Fissured Microlook tegular of ARMSTRONG or Fine Fissured High NRC(Narrow reveal) edge Tiles of Saint Gobain Mineral Fibre Acoustic Ceiling Tiles of size 600 x 600 x 18 mm thick over the formed grid, in module size of 600mm x 600mm x 18mm Thick.				
	The item shall include the cost of additional Tee or L supports & other accessories near the ends/ odd size edges/corners, making necessary openings for electrical light fittings, fire alarm detectors and any other fixtures. No extra payment shall be				

Signature of Bidder with seal

Page 20 of 24

Premises & Estate Section,
Circle Office Hubballi
Centrum Building,

T: 08362-2239432/433 /434

Gokul Road, Hubballi-580030

E:pecohub@canarabank.com

ಸಿಂಡಿಕೇಟ್ ಸಿಂಡಿಕೇಟ್ Syndicate

NIT Ref. COHUB: P&E:DPJ:677: 2024-25 dated 09.07.2024

	made for making openings in the panels/ grid for the purpose of light fittings. Item rate shall include all the taxes, transporation, erection, loading & unloading and any other incidental expenditure that may be required to be spent in completing the work in totality as per above specifications.The tiles removed to place light fittings shall be handed over to bank's custody and there may not be any deduction for light fittings area.				
22.00	GYPBOARD CEILING				
	Providing and fixing suspended false ceiling, which includes providing and fixing GI perimeter channels of size 0.55mm thick having one flange of 20mm and another flange of 30mm and a web of 27mm along with perimeter of ceiling, screw fixed to brick wall/partition with the help of nylon sleeves and screws at 610mm centers. The suspending GI intermediate channel of size 45mm, 0.9mm thick with two flanges of 15mm each from the soffit at 1220mm centers with ceiling angle of width 25mmx 10mmx 0.55mm thick fixed to soffit with GI cleat and steel expansion fastene. Ceiling section of 0.55mm thickness having knurled web of 51.5mm and two flanges of 26mm each with lips of 10.5mm are then fixed to the intermediate channel with the help of connecting clips and in direction perpendicular to the intermediate channel at 457mm centers. 12.5mm tapered edge Gypboard (Conforming to IS- 2095-1982) is then screwed fixed to ceiling section with 25mm dry wall screw at 230mm centers. Screw fixing is done mechanically.	620	Sft		
	Finally the boards are to be jointed and finished so as to have a flush look which includes filling as finishing the tapered and square edge of the boards with joining compound, paper tape and two coats of primer suitable for Gypboard (as equivalent) extra frame work for electrical fittings, A/C diffusers, and/or any other cutout, trap doors, wooden shadow battens (hollock wood black enamel painted-25x40mm) at wall peripheries and ends, 12mm thick MDF board for pelmet etc. complete including opening to be made for AC grills, light fittings, trap doors etc. (The quoted rate shall be inclusive of suspenders at all heights) (The rate to be quoted including plastic emulsion paint)				
23.00	KEY BOARD TRAY				
	Providing and fixing of ready made Key Board tray of approved make size 20" length (minimum) made of metal sheet and finishing with powder coating.The Key board shall be fixed to diffrenet items like counters, tables.	11	No		

Signature of Bidder with seal

Premises & Estate Section,
Circle Office Hubballi
Centrum Building,

Page 21 of 24

NIT Ref. COHUB: P&E:DPJ:677: 2024-25 dated 09.07.2024

24.00	LOGO BOARDS FOR COUNTER ELEVATION				
	Supplying and fixing logo boards on the front laminated surface of counters with 5mm thick acrylic sheet of size 33" x 15", attached with SS glass studs (1" or more). Sticking with blue background and bank logo in the center to be pasted on the back side of the acrylic sheet neatly without any bubbles.	11	No		
25.00	CUSTOMER WRITING DESK.				
	Supplying and fixing free standing customer writing desk of 36" length, 42" height and 18" deep with top, front, side supports and foot rest. There shall be bins of size 6" x6" (front opening) for keeping challans at the top level, all made out of 19mm thick BWP Block board.The top, front and side surfaces laminated with 1mm lamination. All the exposed edges shall be provided with beach wood beadings of size 19mm x 6 mm. All the non laminated surfaces and wood beedings shall be neatly polished with wood polish over a coat of primer. The top shall be provided with 10 mm clear glass edge bevelled fixed with 6 SS studs.	1	No		
26.00	SUGGESTION BOX				
	Supplying and fixing Suggestion Box with front opening with door & lock, slot for dropping letters from top, all made out of 12mm MR grade commercial ply wood. The top, front and side surfaces laminated with 1mm lamination. All the exposed edges shall be provided with beach wood beadings of size 19mm x 6 mm. All the non laminated surfaces and wood beedings shall be neatly polished with wood polish over a coat of primer. The overall size shall be 8" x 10" x 12" (D X W X H).	1	No		
27.00	CHEQUE DROP BOX				
	Supplying and fixing Cheque Drop Box with front opening with door & lock, slot for dropping cheques from top, all made out of 12mm MR grade commercial plywood. The front door shall have 6mm glass 6"x 12" fixed with beach wood beeding. The top, front and side surfaces laminated with 1mm lamination. All the exposed edges shall be provided with beach wood beadings of size 19mm x 6 mm. All the non laminated surfaces and wood beedings shall be neatly polished with wood polish over a coat of primer. The overall size shall be 10" x 12" x 20" (D X W X H)	1	No		
28.00	NOTICE BOARD				
	Providing and fixing notice board of size 6' X 3' by using 19mm thick MR Plywood, with 1 ½" X ½" beach wood beading around. The inside surface	1	No		

Signature of Bidder with seal

Page 22 of 24

Premises & Estate Section,
Circle Office Hubballi
Centrum Building,

T: 08362-2239432/433 /434

Gokul Road, Hubballi-580030

E:pecohub@canarabank.com

ಸಿಂಡಿಕೇಟ್ ಸಿಂಡಿಕೇಟ್ Syndicate

NIT Ref. COHUB: P&E:DPJ:677: 2024-25 dated 09.07.2024

	shall be provided with 12mm thick soft board with fabric on the top. The beach wood eading shall be provided with two coats of polish over a coat of primer.				
29.00	GLASS DISPLAYS				
	Providing and fixing 8mm thick glass panes of required sizes (each disply not exceding an area of 10 sft) with all edges neatly grinded & polished and fixed to the wall surfaces using ' D' brackets / SS studs . The glass shall be plain glass of Modi,saint Gobain,asahi make.	2	sft		
30.00	GLASS SHELFs				
	Providing and fixing glass panes of required sizes (each shelf not exceding an area of 2 sft) with all edges neatly grinded & polished and fixed to the wall surfaces using D brackets. The glass shall be 12mm thk plain glass of Modi,saint Gobain,asahi make.	10	sft		
31.00	FLOOR MAT				
	Providing and supplying vinyl mat of size 3ft x 2 ft durotuff make	NIL			
32.00	TEXTURE PAINTING				
	Wet scrapping on existing surface with sand paper to remove old loose paint layers and providing & applying Plaster of Paris punning/ putty in two layers , followed by texture paint (Royal Play/ Berger Silk Illusions) with one base coats and 2 top coats with roller/spray after preparing the base for the same.	100	sft		
33.00	VERTICAL BLINDS				
	Providing and fixing of Luxaflex / MAC make or equivalant brand window ROLLER blinds with top aluminium channel frame with necessary rolling / folding arrangement.	158	sft		
34.00	ATM ENTRANCE PARTITION WITH DOOR				
	Providing and fixing glazed aluminium framed partition with one door shutter by using 101.6 x 44.4mm-2.1mm thick extruded aluminium sections for the verticals at a spacing of 3ft c/c and 3 horizontals in fixed portion and 2 horizontals in the door opening. The door shutter shall be of 7x3 ft made of 47.62mm x 44.5mm - 1.8mm standard extruded aluminium door sections for the verticals, top, middle and 85 x 44.5mm- 1.8mm for the bottom. The partition & door shutter shall be covered by 8mm thick plain glass of Modi float / saint Gobain / asahi make and fixed with aluminium clipping channel. The glass shall be pasted with white frosted film as per approved design. The door shutter shall be fixed with Floor spring and pivot.	116	sft		

Signature of Bidder with seal

Page 23 of 24

Premises & Estate Section,
Circle Office Hubballi
Centrum Building,

T: 08362-2239432/433 /434

Gokul Road, Hubballi-580030

E:pecohub@canarabank.com

ಸಿಂಡಿಕೇಟ್ ಸಿಂಡಿಕೇಟ್ Syndicate

NIT Ref. COHUB: P&E:DPJ:677: 2024-25 dated 09.07.2024

	There shall be 2 no.s 15" long SS tubular handle and concealed door lock. All the aluminium sections shall be powder coated to approved shade.				
35.00	ATM FALSE CEILING				
	GYP BOARD CEILING (Specification same item no.22)	28	sft		
	GRID CEILING (Specification same as item no 21)	38	sft		
36.00	ATM WALL PANNELING				
	Providing & fixing wall panelling using 50mmx 25mm Aluminium sections of thickness 1.5mm sections for the frame work spaced at 2 ft C/C and clad with 8mm thick MR grade commercial plywood and finished with 1mm thick lamination finish of approved shade. The soffits of the windows shall also be covered with panelling.(Wall panelling shall not be provided behind storages)	114	sft		
37.00	NOTICE BOARD				
	Providing and fixing notice board of size 2 x 3 ft by using 2 no.s of 3mm plain acrylic sheet and sandwiched fixed to the wall with matt finished mirror polished SS studs.	1	Nos		
38.00	Internal Painting				
	Internal Painting ,one coat primer 2 coats of Emulsion paint with approved colour and shade for window grills,All as per architect Direction.	150	sft		
39.00	Enamel paint as per standard Specification for rolling shutter and collapsible gate	200	sft		
40.00	External painting				
	External Painting One Time Water Wash For Exterior Walls ,With Deep Crack Filling ,With One Coat of Primer And 2 Coats of Ace Paint With WeatherProof With Necessary Scaffolding ,All As per Direction.	NIL			
41.00	SHUTTER BOXING FOR Branch and ATM				
	19 MM TH Frame work with MR GRADE PLY WITH 1MM TH APPROVED LAMINATION WITH NECESSARY OPENABLE DOOR IN BOTTOM FOR SERVICING ALL AS PER ARCHITECT DIRECTIONS.	72	SFT		
42.00	Dismantlig of Existinfg Counters, Tables, not reusable materials, etc.	1	LS		

Signature of Bidder with seal

Premises & Estate Section,
Circle Office Hubballi
Centrum Building,

Page 24 of 24