

NIT Ref. COHUB: P&E:DPJ:10816: 2024-25 dated 06.07.2024  
Notice Inviting Tender

**FURNISHING WORKS IN EXISTING PREMISES OF KERUR BRANCH (BAGALKOT RO)**

Location of the Branch/Office	<b>Canara Bank, KERUR Branch</b>
Eligibility of the contractor	Eligible Furnishing Contractors Empanelled With Circle Office: Hubballi
EMD	Exempted for Contractors Empanelled With Circle Office: Hubballi
Address for submission of sealed tenders	Circle Office: Hubballi
Last date & time for submission of sealed tenders	<b>18.07.2024 up to 3:30 pm</b>
Date & Time of opening of sealed tenders	<b>18.07.2024 up to 4:00 pm</b>
Payment terms	As per IBA norms.
Time limit for execution of work	<b>30 days</b> from the date of work order
Defect liability period	12 months after completion of work
Retention money towards defect liability period	3 % of final bill amount
Date of commencement of work	As per work order
Income Tax &/ other taxes	At applicable rate
Payment	After the completion of the work, as per procedure
Period for submitting final bill by contractor	Within one month from the date of virtual completion of the work
Liquidated damage for non completion of work in time	<b>1% OF THE TENDERED AMOUNT per week and part thereof for the delayed period maximum of 5%.</b>
Rates quoted by bidder	<p>I. The quoted rate should be inclusive of Cost of materials, transport, loading , unloading charges, cost of installation, all taxes <b>(excluding GST)</b>, wastages, machinery, temporary works such as scaffolding, cleaning, overheads, profit, statutory expenses, incidental charges and all related expenses required for the completion of the work.</p> <p>II. Additional claims other than the quoted amount will not be entertained.</p> <p>III. The quoted rates shall be firm throughout the completion of the project</p>
Insurance	Falls under scope of contractor.
Validity of submitted tender	90 days from the opening of tenders

The sealed tender must be dropped in tender box kept at the Circle Office within the above stipulated time. Tenderer / authorized representative are requested to be present at the time of opening. Canara Bank will not be bound to accept the lowest tender & reserves the right to reject any or all the tenders without assigning any reason thereof.

NIT Ref. COHUB: P&E:DPJ:10816: 2024-25 dated 06.07.2024

To

The Assistant General Manager,  
P & E Section,  
Canara Bank Circle Office,  
BAGALKOT - 580030.

Dear Sir,

Sub: Furnishing works in the premises of KERUR Branch.

I/We hereby declare that I/ We have carefully gone through the conditions laid down in the Notice Inviting Tender, General notes, General Conditions of Contract, Special conditions, Schedule of approximate quantities and rates, Form of Agreement, General Specification, Approved manufacturers/natural source of materials Technical Specifications of schedule of quantities, and clearly understood all the same and on the basis of the same I/ We have quoted our rates in the Schedule of Quantities(i.e. BOQ) attached with the tender documents.

I / We have enclosed herewith a Demand Draft of \_\_\_\_\_Bank & No. \_\_\_\_\_ dated \_\_\_\_\_ favoring **Premises & Estate Section, Circle Office, Canara Bank, Hubballi** for ₹ \_\_\_\_\_ payable at Hubballi, towards E.M.D.

In the event of this Tender being accepted I/ We agree to enter into the agreement and submit the declaration on requisite non-judicial stamp papers as and when required and execute the contract according to your form of Agreement etc., in default whereof, I/ We do hereby bind my-self / ourselves to forfeit the aforesaid deposit.

I / We further agree to complete the work included in the said schedule of quantities within specified time from the date of the work order issued to commence the same.

I / We agree to pay all taxes(except GST), insurance charges as prevailing from time to time, on such items for whom same is to be levied by/ for the government, and the rates quoted by me / us are inclusive of all the same.

Once again knowing full well the contents of this tender, I / We sign this tender on this \_\_\_\_\_ Day of \_\_\_\_\_ month of 2023.

Signature of the Contractor with seal & date

Signature of Bidder with seal

Premises & Estate Section,  
Circle Office Hubballi  
Centrum Building,

Page 2 of 18

**SPECIAL CONDITIONS & INSTRUCTIONS FOR THE GUIDANCE OF TENDERER**

1. The works at the branch/Office premises need to be executed duly taking care of the local bye laws/regulations of the local authorities like Police Dept, Water supply and Sanitary Board, Electricity Board, Central/ State Labor Commission etc. Necessary permissions, licenses, temporary connections if needed shall be obtained by the Contractor and Bank shall not be held responsible for any lapses.
2. The works shall be executed duly taking care of all safety measures and Bank shall be fully indemnified for any 3<sup>rd</sup> party claims, casualties, mishaps, loss of property etc. related to the undertaking & the execution of the subject work.
3. GST TAXES: As per the new Goods & Services Tax (GST) structure, the tenderer are required to have GSTIN number & Tenderer without GSTIN number are not eligible to participate in the tender process. The details as per the Annexure I attached are to be mandatorily furnished along with the tender. The eligible tenderer are requested to quote the GST separately. The taxes will be deducted at source as per the statutory requirements. While raising the bill, it shall be mentioned as bill to Canara Bank and our Bank's GSTIN number to be mentioned.
4. CANARA BANK'S KARNATAKA STATE GSTIN NUMBER is 29AAACC6106GIZX.
5. Tenderer are requested to submit the EMD in the form of crossed Demand draft only on any of the nationalized Banks/State Bank Drawn in favor of Premises & Estate Section, Circle Office, Canara Bank, BAGALKOT, payable at BAGALKOT. Tender with EMD in any other forms shall be rejected.
6. Tenderer are expected to visit the site before quoting the rates and should satisfy themselves as to the nature and conditions of work facilities available etc.
7. The tenderer are required to examine the enclosed general plan, tender form and conditions mentioned in the tender.
8. The tenderer should quote the rates in the figures. The amount for each item should be worked out and the requisite totals shall be given. The total amount shall be written both in figures and words.
9. The rates quoted in the tender shall be for measured finished works and shall include all changes including cost of materials, transportation, freight charges etc. complete.
10. The work is to be completed within stipulated time.
11. The successful tenderer shall give all necessary personal attention to the work during the process of work and also until the expiry date of "Defects Liability Periods" which is 12 months after the date of completion of the work.
12. The bank reserves the right to reject any portion of the work or material, which is, found unsatisfactory not up to the standard.

**ಸಿಂಡಿಕೇಟ್ ಸಿಂಡಿಕೇಟ್ Syndicate**

NIT Ref. COHUB: P&E:DPJ:10816: 2024-25 dated 06.07.2024

13. A retention amount of **3% of the bill amount** will be retained from the final bill and shall be paid to the successful tenderer after the defects liability period is over and upon the certification of the engineer.
14. Income tax deduction at prevailing / appropriate rates will be retained from each running bill which will be certified by the income tax authorities and a receipt will be given to the contractors.

**CONDITIONS OF CONTRACT**

1. If any additions and alterations are found necessary, the tenderer will have to do the same within the tendered rates with the prior approval of the bank.
2. The contractor shall employ adequate labor to complete the work within the scheduled time and shall make his own arrangements for housing his materials etc.
3. The contractor shall have to make his own arrangements to house his labor and staff for their services.
4. All tendered rates shall include for the cost of materials, labor, supervision, tools, plant, transportation, contingencies, duties, breakages, wastages, sundries, scaffolding, etc complete.
5. All instruction regarding the execution of the work shall be received from the officials through consultant/architect only. Any other instructions issued directly to the contractor by anyone else shall not be binding on the bank.
6. The bank shall have the power to omit or cancel any item of work without assigning any reason whatsoever and no claim for compensation for damage will be entertained for such omissions and cancellation.
7. The contractor shall maintain satisfactory progress of work as well as maintain a desired level of workmanship. If in the opinion of the bank the progress is unsatisfactory and / or the workmanship is unsatisfactory then the bank shall take possession of the work within 7 days to that effect. The bank shall then complete the entire work and rectify all the defects at the contractor's cost and consequences.
8. In case the bank is not satisfied with the quality of materials used by the contractors, they reserve the right to direct the contractor to procure such materials supplied from agencies they deem fit.
9. The contractor is to be responsible for clearing any, all dirt and rubbish and superfluous materials as they accumulate and everything unnecessary and to leave the premises in a clean and orderly condition on completion and fit for occupation. No extra payment shall be made for doing this.
10. Any work which is not approved by the bank shall have to be removed within 24 hours from the time of order and shall have to be redone by the contractor at his own cost and this cost will be borne by the contractor.
11. No deviation whatsoever for any reason will be permitted, however, if any deviation becomes necessary, the same should be brought to the immediate notice of the bank and written approval must be obtained for such deviation before proceeding with the execution of work.

Signature of Bidder with seal

Premises & Estate Section,  
Circle Office Hubballi  
Centrum Building,

Page 4 of 18

**ಸಿಂಡಿಕೇಟ್ ಸಿಂಡಿಕೇಟ್ Syndicate**

**NIT Ref. COHUB: P&E:DPJ:10816: 2024-25 dated 06.07.2024**

12. The bank has got the right to supply any materials required for the work and cost of materials so supplied will be deducted from the bills of the successful contractor.
13. The contractor shall be responsible for safe custody of his materials/materials issued to him by the bank till they are used for the work. He shall make his own arrangements for the safe custody and proper storage and preservation in sound condition till the same are actually used in the work.
14. The tenderer shall extended full co-operation to the other contractor /agencies like electrical, air conditioning, Fire & CCTV, LAN etc who are also working for the same project and co-ordinate with them in finishing the awarded work within the stipulated time given.
15. The contractor shall have a competent supervisor on the site for all the time.
16. For any new item the rate will be fixed by the bank as per prevailing fair market rate and labor which will be binding on the contractor.
17. In case the brand of materials mentioned in the tender is not available in the market, the alternate brand shall be used only after prior written approval of the bank.
18. The contractor shall be given a single electrical connection at work site. Electrical charges for consumption by the contractor will be charged separately by the bank, contractors have to provide sub-meter.
19. The successful tenderer shall not anticipate any financial help from the bank in the form of adhoc payment / advance for mobilizing and for starting the work.
20. The contractor should strictly adhere to the specifications and make of the materials, mentioned in the annexure. Any deviation will summarily reject the items of the work and not qualify for payment.
21. The successful tenderer shall be ready to carry out works between non banking hours and even at nights and holidays. The contractor should sign all the pages of the document and the same shall be submitted to us.

**Acceptance of contractor for Labor laws**

- The successful tenderer / Contractor shall carefully and diligently implement the provisions of the Contract Labor Act & Contract Labor Rules.
- The Bank shall be entitled to deduct from the Contract Consideration, any such amount which the Bank has to pay in accordance with the Contract Labor (Regulation & Abolition) Act 1971 and Workmen's Compensation Act, in the event of the Bank having to disburse compensation / effect any payment under the Contract Labor Acts / Rules.
- Please note that as per rule 81(1) of Contract Labor (R&A) Rules, 1971, it is mandatory on the part of the Contractor to the display the notice containing the following details at prominent place at the work site.
  - a) Rates of wages.
  - b) Hours of work.

Signature of Bidder with seal

Premises & Estate Section,  
Circle Office Hubballi  
Centrum Building,

Page 5 of 18

NIT Ref. COHUB: P&E:DPJ:10816: 2024-25 dated 06.07.2024

- c) Wage periods.
- d) Dates of payment of wages.
- e) Names & addresses of the Labor Inspectors having jurisdiction &
- f) Date of payment of unpaid wages.

The notice containing the above details shall be displayed without fail at the work site.

1. The Contractor shall not engage any workmen for wages, less than the minimum wages prescribed under the notification issued by the Central Government.
2. The contractor should follow all labor laws/guidelines laid down by central /state government from time to time.
3. ABNORMALLY HIGH AND LOW RATED ITEMS :

For item rate tenders if, the rates quoted by the lowest bidder for certain items of the Bill of Quantities of the tender are found to be abnormally high or low in comparison to the market rate analysis of the item done by the Architects/Bank and or in comparison to Architect/Bank's method of working out market rate justification for the items, the same shall be governed as under in order to avoid financial loss to the Bank in the event of default of Bidders.

- i. For abnormally high rated items (AHR), the progressive payment shall be 80% (eighty percent) of the payment due to the Bidder against execution of the AHR item. The balance withheld 20% payment shall be released after 75% of total value of the original contract is complete in financial terms or this 20% withheld payment can be released to the Bidder on submission of an unconditional bank guarantee of equivalent amount in the proforma of Bank. Further deviation limit for AHR items shall be nil on plus side and Bank reserves the right to restrict, substitute or not execute the AHR items during execution. The decision of the Architect/Bank's Engineer in this regard shall be final and binding on the Bidder.
- ii. For abnormally low rated (ALR) items the Bidder shall submit Bank Guarantee of difference in total of amount of ALR item(s) and the total amount of corresponding items at market rate of the Architect/Bank. This bank guarantee shall be valid till completion of the project. In exceptional circumstances, the amount of Bank Guarantees (BG) may be reduced or BG released earlier than completion period if, in view of Architect/Bank's Engineer, all ALR items as provided in the contract are executed as per terms of contract and/or not required to be executed.

Notwithstanding what is contained in Para i) & ii) above, the provisions of Para (i)and (ii) shall not be applicable on tenders invited on percentage rate basis.

The decision of the Bank on identification/ marking of AHR and ALR item are final and binding on the Bidder. In case the Bidder do not agree for furnishing of Bank Guarantee as above towards ALR items, at the time of award of works, the EMD/Performance guarantee of the Bidder shall be forfeited and decision of Architect in this regard shall be final and binding on the Bidder.

### CERTIFICATE

I / WE HAVE READ, FULLY UNDERSTOOD THE ABOVE MENTIONED REGULATIONS OF LABOUR LAWS/GUIDELINES AND ACCEPT THE SAME IN TOTO. I ALSO UNDERTAKE TO FOLLOW ALL LABOUR LAWS/GUIDELINES LAID DOWN BY CENTRAL /STATE GOVERNMENT FROM TIME TO TIME & INDEMNIFY THE BANK AUTHORITIES.

Signature of Bidder with seal

Premises & Estate Section,  
Circle Office Hubballi  
Centrum Building,

Page 6 of 18

**ANNEXURE I (TO BE MANDATORILY FURNISHED)**

1.	Name of the Contractor under the Contract Labor (Regulation and Abolition) Act, 1970 (37 of 1970) (if applicable)	
2.	LIN / PAN No	
3.	Email Id	
4.	Mobile No.	
5.	No. & date of Certificate of Registration/ License*	
6.	Name of Person in charge of work	
7.	LIN / PAN No. of the person in charge of work	
8.	Email Id of the person in charge of work	
9.	Mobile No. of the person in charge of work	

\* Please strike off whichever is not applicable

**APPROVED LIST OF MATERIALS**

1	Wood: All wood must be well seasoned, free from knots, other defects, decay and defects due to handling and transportation. Wherever necessary provide with anti termite treatment.	Sal wood/ Thali wood (imported)
2	Teak Wood	Old Burma Teak
3	Marine grade plywood (BWF PF bounded)	ISI marked, complying to BIS specifications <b>UNIPLY/ KITPLY/ CENTURY PLY/ ARCHID PLY</b>
4	MR grade commercial plywood 4mm/6mm/12mm/ 19mm/25mm sizes.	ISI marked, complying to BIS specifications <b>UNIPLY/ KITPLY/ CENTURY PLY/ ARCHID PLY</b>
5	Veneers	Anchor/Green Ply / Century / Euro
6	Laminate: Design , shade, finish as per Architect's Selection confirming to IS: 2046	Decolote- formica/ Marino/ mica Greenlam / Meriono / Euro
7	Powder coated track, ceiling	Interarch, Vista - levotor, Luxalon
8	Hinges, tower bolts, handles	Brass oxidized/ epoxy powder coated ( heavy duty)
9	Glass, Float Glass	Saint-Gobain / Modiguard / Asahi
10	Adhesive materials	Fevicol ( pidilite make)
11	Powder coated aluminum partitions (15.20 micron two step electrical color process using polyester powder)	Jindal / Indal/ Hindal ( Heavy Gauge 1.2 mm th, 15.20 micron 2 Step thick electrical color process Using polyester powder)
12	Pre laminated boards confirming to IS: <b>12823: 1990</b>	Novopon /Eco board (Exterior grade only)
13	Floor springs confirming to IS: <b>6315/</b> door closure confirming to IS: <b>3564</b>	OZONE/ HAFELE/EBCO
14	Fixtures	All hardware fittings & fixture are to be powder

**ಸಿಂಡಿಕೇಟ್ ಸಿಂಡಿಕೇಟ್ Syndicate**

NIT Ref. COHUB: P&E:DPJ:10816: 2024-25 dated 06.07.2024

		coated. Color, finish as per <b>Bank's</b> specification, Godrej makes.
15	Melamine Polish	Asian Paint / ICI / Nerolac
16	External Emulsion (Anti-flasking, Anti-fungal)	Asian (Ace)/ Nerolac/ Berger/Dulux Sample to be approved by the Architect.
17	Oil Bound Distemper	Asian / Nerolac/Berger/Dulux Sample to be approved by the Architect.
18	Synthetic Enamel Paint	Asian /Nerolac/Berger/Dulux. Sample to be approved by the Architect.
19	Automobile Duco paint	MRF / ICI / Asian
20	Carpet Tiles	Nylon carpet tile -shaw/Milliken/Bentley prince
21	Cement	ACC, UltraTech, Ambuja - 43 grade
22	Bricks	Burnt bricks with minimum strength of 35KG/Cm <sup>2</sup>
23	Hinges / drawers	Earl-Bihari Pvt Ltd, Godrej
24	Steel	HYSD bars with FE-415 grade
25	Vitrified tiles	Naveen / RAK / Nitco / Kajaria
26	Ceramic Tiles	H & R Johnson/Bell/Kajaria/Naveen /Spartek.
27	Glazed Tiles	H & R Johnson/Bell/Kajaria /Spartek/ Naveen
28	Tiles fixing adhesive	Algitile / Balgrout.
29	False Ceiling tiles	Armstrong or equivalent only
30	Italian Marble	Classic / Nitco / Elegance
31	Vertical / roller blinds	Hunter Douglas, Mac, Vista, Technifab
32	Wall paper	Marshall / ego / softek
33	Glass film	GARWARE OR EQUIVALENT
34	Drawers / cupboards Locks	Godrej / Yale / Hafele / Dorma Laxmi Make
35	Door Locks	SS finished Mortise lock of Laxmi make
36	PVC Pipes	Finolux /Prince
37	M.S.Pipes	Tata
38	Sanitary Ware	Parry ware /Hindustan sanitary
39	Granite slab 20 mm thick	Edges shall be rounded. Beveled.
40	Vinyl flooring (2mm thick)	Royal House
41	Door closure	Everite/ Godrej/ Hafele
42	Steel	Kamadhenu

Note: Samples are to be approved by Bank and Architect if any. Any brands indicated under the items specifications in the Bill of quantities will prevail over the above indicated makes.



## ಸಿಂಡಿಕೇಟ್ ಸಿಂಡಿಕೇಟ್ Syndicate

NIT Ref. COHUB: P&E:DPJ:10816: 2024-25 dated 06.07.2024

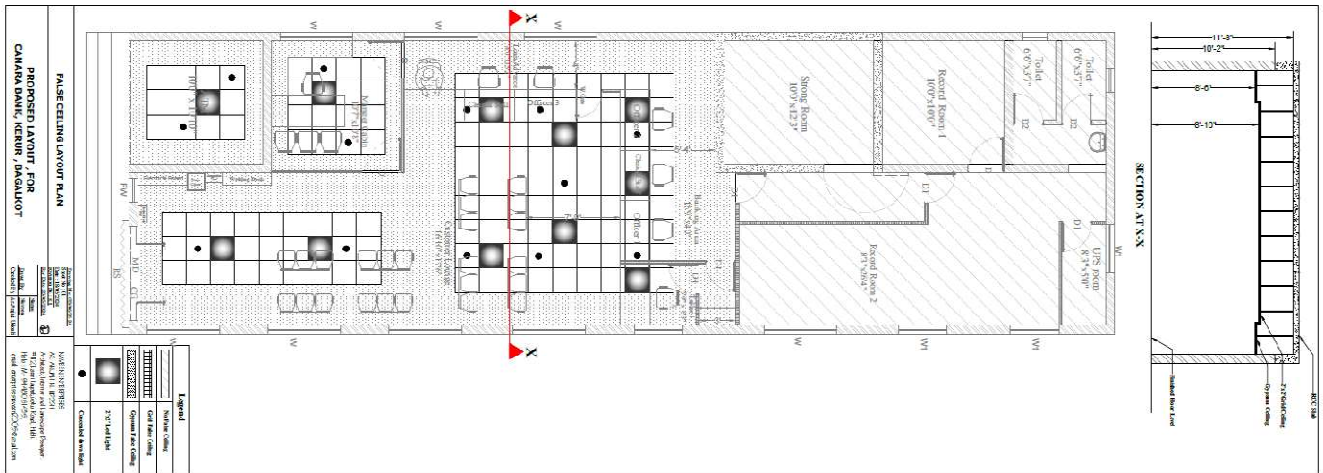
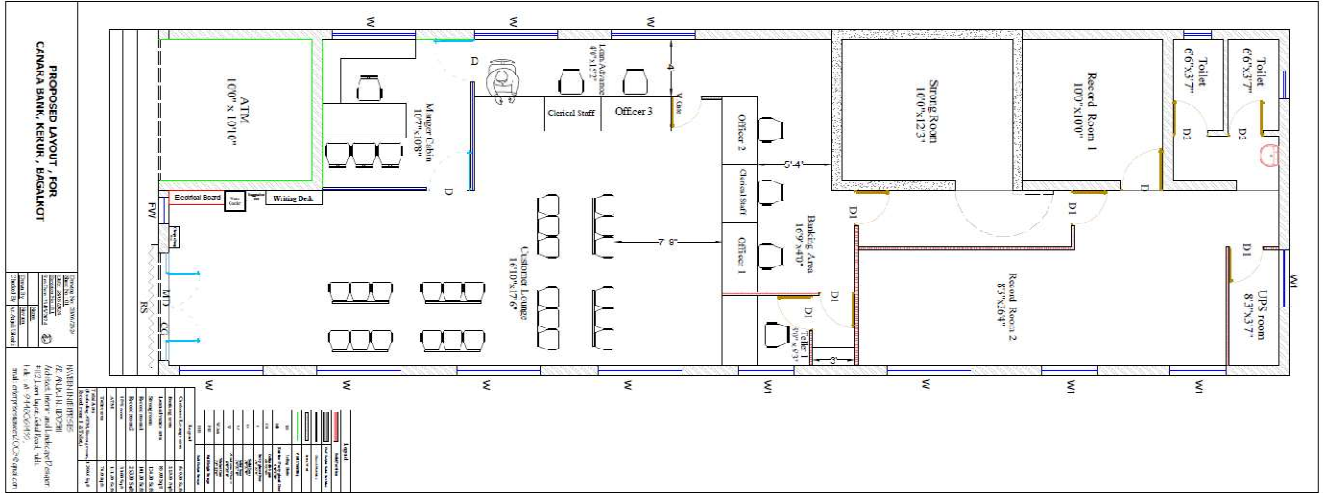

Signature of Bidder with seal

Premises & Estate Section,  
Circle Office Hubballi  
Centrum Building,

**ಸಿಂಡಿಕೇಟ್ ಸಿಂಡಿಕೇಟ್ Syndicate**

NIT Ref. COHUB: P&E:DPJ:10816: 2024-25 dated 06.07.2024

SLNO	DESCRIPTION	QTY	UNIT	RATE	AMOUNT
1	<b>Solid Partitions/Partly glazed Partitions (for Manager cabin/ ups/ filing/ record room and such other areas) :</b>				
	Providing & fixing partitions, the frame made by using 2"x2" size seasoned hard wood sections of approved species for all horizontals and verticals spaced at 2 feet c/c or part thereof, both horizontally and vertically for supporting frame work. All the panels and on both sides of the partition to be covered with 6mm thick MR grade plywood confirming to IS:303 and covered with 1mm thick laminate of approved colour and brand . Necessary openings must be made in the frame sections to run the wires, computer cables wherever necessary. Similarly necessary cuttings to be made in the partition to fix switch boxes of electrical, telephone sockets, computer Information outlets etc.				
a	<b>Solid Partitions :</b> Full Height Solid Partitions, with frame work upto the true ceiling. The panels upto the false ceiling will be covered with 6 mm thick MR grade plywood & laminate finish. Only the area visible below false ceiling will be considered for payment. <b>(UPS &amp; Record Room)</b>	449.00	SFT		
b	<b>Partly Glazed Full Height Partition:</b> Same as Full Height Partition, but the central panel of the partition above 3 feet upto 7 feet level covered with 6 mm thick plain glass instead of plywood, held with first quality wooden beading & laminate finish. The rate should be inclusive of providing frosted film to glass of 3M make or equivalent as per Bank approved design. <b>( Manager Cabin)</b>	139.00	SFT		
2	<b>CASH CABIN FRONT PARTITION :</b>				
	Providing and fixing partition for cash cabin front by using 2.5"x2.5" size well seasoned hard wood sections of first class quality for all horizontals and verticals.The exposed surface of wood shall be finished with 1mm thick lamination of approved colour. There shall be atleast three horizontals at 0' 0', 0'8" and 3'3" levels [approx] upto the customer counter top level (which will be at 42 inches height from floor level). The customer transaction top shall have a customer ledge of width 6" (towards customer side) made of 19 mm thick block board with 1 mm thick laminate finish & a 12" width ledge towards the cashier side, portion of which say 9 inches wide for the full length of 5 feet shall be made of 12 mm thick clear glass (all average dimensions) all as shown in the drawing. The front,working top,customer top, main vertical side support shall be made out of 19 mm thick MR grade ply wood confirming to IS:303 & finished with 1mm thick laminate on all visible sides.				
	The vertical supports on both ends of the cash counter will be upto a height of 7 ft height from floor level. The bottom 8" height panel above the customer top level to be covered by 7.5 mm thick 56mm x 47mm opening aluminium grill ( AL 101 ) fixed with suitable corner beadings, rubber beadings. At the mid portion of the panel there shall be an opening of 6" x 6" with around frame work & this opening shall have a	43.00	SFT		

**ಸಿಂಡಿಕೇಟ್ ಸಿಂಡಿಕೇಟ್ Syndicate**

NIT Ref. COHUB: P&E:DPJ:10816: 2024-25 dated 06.07.2024

	sliding or openable type shutter with locking arrangement from inside to facilitate cash receiving/ paying. The top panel shall be covered by two glass panels made of 12 mm thick plain glass fixed with necessary beedings with an intermediate horizontal gap between two glass panels to facilitate communication between customer and cashier. The glass panel shall have designed artistic etching using frosted film. (Teller 1)				
3	<b>CASH CABIN SIDE PARTITION :</b>				
	Providing and fixing partitions for cash cabin sides by using frame made of 2.5"x2.5" size well seasoned hard wood sections of first class quality for all horizontals and verticals spaced at required intervals but not more than 3 feet c/c unless otherwise specified. There shall be atleast 4 horizontal wood sections at 0" 0', 2'0", 3'6" and 7'0" levels [approx] from the floor level. There shall be vertical supports for every 3 feet interval or part there of.				
	The bottom 3'6" height panel to be covered by 6mm thick MR grade plywood confirming to IS:303 on both sides and finished with 1mm thick lamination. The top remaining panels shall be covered by 7.5 mm thick 56mm x 47mm opening aluminium grill ( AL 101 ) fixed with suitable corner beadings, rubber beadings. There shall be a horizontal tray at 3 ft level to facilitate slips movement and communication between supervisor and cashier.	98.70	SFT		
4	<b>WORKING TABLE FOR CASH CABINS :</b>				
	Providing and fixing table for teller Counter . The counter shall have overall size of 2' 6" (W) x 5' 0" (L) x 2' 6" (H) working top . The countertop, verticals and intermediate support and the drawers shall be made by using 19mm MR grade Blockboard except for draw bottom, which shall be provided with 8 mm MR grade plywood both confirming to IS:303. There shall be three drawers of size 13.5"x 22"x 5" (internal dimensions) fixed in between the intermediate support and main support. The first two drawers will have cash partitions made of 6mm Plywood. The drawers will be fixed with telescopic type metal channels. Each drawer/cupboard shall have one multipurpose concealed lock and 3" long brass or stainless steel handle. A footrest of 3" x 2" hardwood section with proper painting finish shall be provided. The inside & hidden surfaces to be polished to the required colour with 2 coats of colourless french polish. The laminate colours for the counter/ table top, vertical sides, bands, skirting etc. shall be strictly as per the recommended colours indicated by Bank. There shall be a round hole of 2'6" size with PVC cap at the required location for wire management.	1.00	NOS		
5	<b>WOOD FRAME LAMINATED DOOR FOR BULK CASH CABINS :</b>				

**ಸಿಂಡಿಕೇಟ್ ಸಿಂಡಿಕೇಟ್ Syndicate**

NIT Ref. COHUB: P&E:DPJ:10816: 2024-25 dated 06.07.2024

	Providing and fixing of wood framed door of size 7 feet x 2'6" wide [approx] using 3" x 2" well seasoned hard wood sections for the top, bottom and verticles, 5" x 2" for the middle lock rail. All sectional dimensions are minimum. The bottom 3 feet height panel to be covered by 6mm thick MR grade plywood on both sides & finished with 1.0 mm thick laminate of approved colour and make. The top 3 feet panel to be covered with 6mm thick plain glass, using necessary moulded corner Teak / beach wooden beading. The edges of the shutter shall be lipped with 6mm thick Teak / beach wood beeding. The door shutter shall be fixed with 3 nos stainless steel (SS) make 5" size hinges, one number 6 levered Godrej make (with minimum 3 keys) automatic NIGHT LATCH fixed just below 3 feet level and one 3" long SS material tower bolt and 4" long SS handles on both the sides. All exposed wood shall be neatly finished with 2 coats of polish & stained to required colour.	2.00	NOS		
6	<b>ALUMINIUM GRILL FOR CASH CABIN TOP :</b>				
	Providing & fixing 7.5mm thick 56mm x 47mm aluminium grill (AL 101) at the top of the cash cabin with necessary hard wood beading. All the accessories used shall be concealed type. All the aluminium sections shall be powder coated.	50.00	SFT		
7	<b>FRONT OFFICE CUSTOMER COUNTER (WITH CUSTOMER HOOD) :</b>				
	Providing and fixing Running customer counter of total height 30" and working top width of 30" width (all minimum dimensions) all as per drawing with front, working top, main vertical support upto the working top at every 5ft c/c and intermediate vertical support for draw unit upto working top. There shall be two drawers of size 13.5"x 22"x 5" (internal dimensions) fixed in between the intermediate support and main support at every 5ft c/c. The portion below the drawers shall have a cupboard with front shutter. The counter and the drawers shall be made by using 19mm thick MR grade plywood except for draw bottom, which shall be provided with 8 mm commercial plywood. There shall also be a key board tray of minimum 21" x 9" size made of 19mm MR grade plywood with both side laminate, fixed on the lower side of the counter/table top. Both the keyboard and the drawers will be fixed with telescopic type metal channels, a foot rest made of 3"x2" hardwood section with proper painting finish. Each drawer/cupboard shall have one multipurpose concealed lock and 3" long brass or stainless steel handle. Necessary openings for the access of the wires with plug shall be provided with PVC caps for the counter top at appropriate location. The working top & front elevation and other exposed edges will be finished with 1mm thick laminate of approved colour and shade.				

**ಸಿಂಡಿಕೇಟ್ ಸಿಂಡಿಕೇಟ್ Syndicate**

NIT Ref. COHUB: P&E:DPJ:10816: 2024-25 dated 06.07.2024

	The front elevation of the counter shall be as per the design detailed in the drawing using 8mm thick glass held with suitable architectural hardware. All exposed edges of the glass will be ground and polished shall be provided with polished teakwood beadings of size 1" x ¼" .	28.20	RFT		
8	<b>MANAGER TABLES :</b>				
	Providing and fixing table of size as specified, with working top and side supports. There shall be three drawers of size 13.5"x 22"x 5" fixed in a around boxing with top and one of the side of the table as common top and side. All by using 19mm MR grade Plywood except for drawer bottom which shall be provided with 8mm MR grade plywood .The drawers shall have sliding arrangement by using readymade telescopic sliding channels. The working top, sides,front face of drawers shall be finished with 1mm thick lamination. Each drawer shall have stainless steel handle with a centralized locking system for the three drawer unit. Necessary openings for the access of the wires with plug shall be provided inclusive of working top and covered with PVC caps as per Drawing.				
	There shall be shelf of size 10"x20" below the working top for CPU UNIT using 19mm MR grade Plywood confirming to IS:303.There shall be one shelf of size 36"x20" below the working top for CC camera CPU. A foot rest of 3"x1 1/2" hardwood section shall be provided. The front elevation of the table shall be as per the design detailed in the drawing using 6mm thick teak wood to provide recession and finished with TW beadings ,1mm laminate.All the exposed edges shall be provided with teakwood beadings of size 1"x1/4" polished. All non laminated exposed surfaces shall be provided with two coats colourless French polish.				
a	Manager Table of 6'0" (L) x 2'6" (W) x 2' 6" (H)	1.00	NOS		
9	<b>SIDE STORAGE UNITS :</b>				
	Providing and fixing storage units of following sizes, with necessary swing shutters, all made of 19mm thick MRgrade block board confirming to IS:303 grade for sides, partitions, top, shelves, bottom, shutters. The exposed surfaces including rear surface shall be finished with 1mm thick lamination of approved shade & brand. Unit shall have internally one horizontal shelf and one vertical partition in the centre all made with 19mm thick MR grade block board. All internal and hidden surfaces shall be finished with 2 coats of Colourless French polish stained to suitable colour. 12mm thick MR grade plywood to be fixed for the rear surface cover with 1.0 mm thick colour laminate.				
	All the exposed edges shall be lipped with 3/4"x1/2" matching Wood Beading & neatly polished with 2 coats with matching colour. The shutters shall have locking arrangement Brass 3" size handles, Ball catch, Continuous SS hinges, 3" PC Aluminium Tower bolts as per the requirement.				

**ಸಿಂಡಿಕೇಟ್ ಸಿಂಡಿಕೇಟ್ Syndicate**

NIT Ref. **COHUB: P&E:DPJ:10816: 2024-25 dated 06.07.2024**

a	Manager Side Table L- Shape of 8'6" (L) x 1'4" (W) x 2' 6" (H)	1.00	NOS		
10	<b>ENTRANCE DOOR :</b>				
	Providing and fixing fully glazed entrance door of double leaf shutter as per the following specifications. For around supporting door frame 5"x3" section made out of 25mm thick MR grade block board confirming to IS:303 grade, neatly finished with 1mm thick laminate of TW/beach wood colour and shall have necessary offset/recess area to fit door shutter thickness. Each shutter shall be fully glazed and shall be made of 12mm thick plain glass fixed using 5"x2 ¼" first quality Teak wood sections at both top and bottom levels. The edges and sides of the glass shutters shall be neatly grinded & polished. There shall be 12mm wide double line frosted film pasted with etching like design around the shutter and horizontal strips with bank emblem at the centre portion of the glass shutters.				
	The Teak wood sections shall be neatly polished with two coats of wood polish & stained to the required colour. Each shutter shall be fixed firmly with necessary pivot hinges at the top and a floor spring of OZONE make at the bottom (cost of floor spring will be paid separately) . The shutters shall have decorative stainless steel handles of minimum 12" length on both sides of the shutter. The normal width of the entrance will be 5'0" and design shall be as per the instructions of the Architect / Bank. Shutter width shall not be more than 3 ft.	35.00	SFT		
11	<b>MAIN ENTRANCE DOOR SURROUNDING PANELLING :</b>				
	Providing and fixing WOODEN PANELLING surrounding the entrance door/s as per the following specifications. Around supporting frame work as well as intermediate frames as per the directions of the Engineer in charge, shall be made out of 5" x 3" section prepared using 25mm thick MR grade blockboard neatly finished with 1mm thick laminate of TW/beach wood colour. The panels above 7ft level shall be finished with 6mm thick commercial plywood and 1mm thick laminate on both sides. Panels below 7ft shall be covered with 6 mm thick plain glass fixed with corner wood beadings, as required depending on the site condition. The glass panes to be covered with approved design 3M make frosted film as per approved design.	21.80	SFT		
12	<b>FLOOR SPRING :</b>				
	Providing & Fixing floor spring of OZONE make at the bottom of the main entrance door.	2.00	NOS		
13	<b>ROLLER BLINDS :</b>				
	Providing and fixing of Luxaflex / MAC make or equivalent brand window ROLLER blinds with top aluminium channel frame with necessary rolling / folding arrangement.	310.00	SFT		
14	<b>WALL/ COLUMN PANELLING : (TO BE DONE ONLY AFTER CONSULTING CO TFO)</b>				

**ಸಿಂಡಿಕೇಟ್ ಸಿಂಡಿಕೇಟ್ Syndicate**

NIT Ref. COHUB: P&E:DPJ:10816: 2024-25 dated 06.07.2024

	Providing & fixing wall panelling using 8 mm thick MR grade commercial plywood fixed over a 2ft x 2ft grid made of 2" x 2" frame work. The frame work shall be made out of 25mm thick commercial plywood to get required sizes. Over the frame work 12 mm thick commercial plywood to be fixed and covering the same with 1.0 mm thick laminate of approved brand and shade and as per the design. At certain locations, space for soft board/pin up boards fixing, paintings area to be prepared with around matching wooden beadings. The cost of such works shall also to be part of the item rate. Design will be decided during working along with premises incharge & Engineer.	423.00	SFT		
15	<b>MINERAL FIBRE BOARD GRID TYPE FALSE CEILING :</b>				
	Providing, fabricating, erecting lay-in type tegular/ drop type Mineral fibre board false Ceiling of 600mm x 600mm grid as per the following specifications.The approved brands are ARMSTRONG/SAINT GOBAIN. The following specifications are the minimum and tenderers may quote for the equivalent or better specification.				
	The grid system having 600mm x 600 mm or part thereof wherever necessary, shall be made using hot dipped galvanized steel section, exposed surface chemically cleaned capping prefinished in backed polyester paint, main Tee of size 14 x 38 x 0.33mm at every 1200mm c/c max and rotary stitched cross tee of size 14 x 38 x 0.33mm at every 600mm c/c and cross Tee of size 14x 38 x 0.33mm at every 1200 c/c max and 14 x 22 x 0.457mm wall angle around the wall to form grid size of 600 x 600mm. The suspension system shall have 4mm dia pre-straightened GI rods which are in-turn supported from real ceiling using 6mm size anchor bolts, connected with adjustable Hanger clips/ J bolts and other accessories as per the manufacturers specifications. The T Sections have a Galvanizing of 120 grams per M2 & passed through for 500 hrs of Salt test.				
	The tiles/ panels shall be of prima Fine Fissured Microlook tegular of ARMSTRONG or Fine Fissured High NRC(Narrow reveal) edge Tiles of Saint Gobain Mineral Fibre Accoustic Ceiling Tiles of size 600 x 600 x 18 mm thick over the formed grid, in module size of 600mm x 600mm x 18mm Thick.				
	The item shall include the cost of additional Tee or L supports & other accessories near the ends/ odd size edges/corners, making necessary openings for electrical light fittings, fire alarm detectors and any other fixtures. No extra payment shall be made for making openings in the panels/ grid for the purpose of light fittings. Item rate shall include all the taxes, transporation, erection, loading & unloading and any other incidental expenditure that may be required to be spent in completing the work in totality as per above specifications.The tiles removed to place light fittings shall be handed over to bank's custody and there may not be any deduction for light fittings area.	544.00	SFT		

**ಸಿಂಡಿಕೇಟ್ ಸಿಂಡಿಕೇಟ್ Syndicate**

NIT Ref. COHUB: P&E:DPJ:10816: 2024-25 dated 06.07.2024

16	<b>GYPBOARD CEILING :</b>				
	Providing and fixing suspended false ceiling, which includes providing and fixing GI perimeter channels of size 0.55mm thick having one flange of 20mm and another flange of 30mm and a web of 27mm along with perimeter of ceiling, screw fixed to brick wall/partition with the help of nylon sleeves and screws at 610mm centers. The suspending GI intermediate channel of size 45mm, 0.9mm thick with two flanges of 15mm each from the soffit at 1220mm centers with ceiling angle of width 25mmx 10mmx 0.55mm thick fixed to soffit with GI cleat and steel expansion fastener. Ceiling section of 0.55mm thickness having knurled web of 51.5mm and two flanges of 26mm each with lips of 10.5mm are then fixed to the intermediate channel with the help of connecting clips and in direction perpendicular to the intermediate channel at 457mm centers. 12.5mm tapered edge Gypboard (Conforming to IS- 2095-1982) is then screwed fixed to ceiling section with 25mm dry wall screw at 230mm centers. Screw fixing is done mechanically.				
	Finally the boards are to be jointed and finished so as to have a flush look which includes filling as finishing the tapered and square edge of the boards with joining compound, paper tape and two coats of primer suitable for Gypboard (or equivalent). Extra frame work for electrical fittings, A/C diffusers, and/or any other cutout, trap doors, wooden shadow battens (hollock wood black enamel painted-25x40mm) at wall peripheries and ends, 12mm thick MDF board for pelmet etc. complete including opening to be made for AC grills, light fittings, trap doors etc. (The quoted rate shall be inclusive of suspenders at all heights) <b>(The rate to be quoted including plastic emulsion paint). Only the Horizontal area of Ceiling will be considered for Payment.</b>	651.00	SFT		
17	<b>FLUSH DOORS FOR MANAGER CABIN,UPS,RECORD ROOM ETC :</b>				
	Providing & fixing wooden solid core flush shutters of 35 mm thickness with both sideMR grade plywood and around wooden frame work. The top 4 feet portion shall be finished with 6mm thick plain glass fixed with wooden moulded beadings & pasted with frosted film having Bank's logo and strips as per the design provided by Engineer-in-charge.				
	Both sides of the shutter shall be finished with 1 mm thick approved colour & brand laminate. The around edges shall be with teak wood lipping beading. The door shall be fixed to the partition frame work using 4 nos stainless steel hinges, 2 nos 6" size S S handles, one 6 lever SS finished Mortice lock of approved make, door closure of Everite make, door stopper. The payment is per number of 3'x7' size. Any variation in size will be paid on proportionate basis.				
a	Partly Glazed Door for Chief Manager Cabin with viewing Glass Panel ( 7' x 3')	2.00	NOS		
b	Record & UPS Room Solid Door without Glass	3.00	NOS		

Signature of Bidder with seal

Page 16 of 18

Premises & Estate Section,  
Circle Office Hubballi  
Centrum Building,



**ಸಿಂಡಿಕೇಟ್ ಸಿಂಡಿಕೇಟ್ Syndicate**

NIT Ref. COHUB: P&E:DPJ:10816: 2024-25 dated 06.07.2024

	(Solid Door - 7' x 3')				
18	<b>CUSTOMER WRITING DESK :</b>				
	Supplying and fixing free standing customer writing desk of 39" length, 42" height and 12" deep with top, front, side supports and foot rest. There shall be bins of size 6" x6" ( front opening ) for keeping challans at the top level, all made out of 19mm MR grade block board confirming to IS:303 grade.The top, front and side surfaces laminated with 1mm lamination and remaining surfaces neatly painted with two coats of synthetic enamel paint over a coat of primer.	1.00	Nos.		
19	<b>SUGGESTION BOX :</b>				
	Supplying and fixing Suggestion Box with front opening with door & lock, slot for dropping letters from top, all made out of 19mm MR grade Plywood confirming to IS:303 grade. The top, front and side surfaces laminated with 1mm laminate and remaining surfaces neatly painted with two coats of synthetic enamel paint over a coat of primer . The overall size shall be 18" (L) x 9" (D) x 12" (H).	1.00	No.		
20	<b>CHEQUE DROP BOX :</b>				
	Supplying and fixing Cheque Drop Box with front opening with door & lock, slot for dropping cheques from top, all made out of 19mm MR grade Plywood confirming to IS:303 grade. The top, front and side surfaces laminated with 1mm lamination and remaining surfaces neatly painted with two coats of synthetic enamel paint over a coat of primer .The overall size shall be 18" (L) x 9" (D) x 12" (H).	1.00	No.		
21	<b>GLASS TOPS :</b>				
	Providing 8mm thick glass for Manager table top required sizes with all edges neatly grinded & polished. The glass shall be plain glass of Modi,Saint Gobain,Asahi make.	15.00	SFT		
22	<b>GLASS SHELFs :</b>				
	Providing and fixing 12mm thick glass panes of required sizes (like 1 ft x 2 ft, 9" x 15" etc) with all edges neatly grinded & polished and fixed to the wall surfaces using D brackets. The glass shall be of Modi, Saint Gobain, Asahi make.	6.00	SFT		
23	<b>NOTICE BOARD :</b>				
	Providing and fixing notice board of size 4'x4' - 2 nos by using 19mm MR grade block board with 1 ½" x ½" TW beading around. The inside surface shall be provided with 12mm thick soft board with fabric on the top. The TW beading shall be provided with two coats of paint over a coat of primer.	32.00	SFT		
24	<b>WICKET GATE :</b>				
	Providing & fixing in position Flap Gate made out of 19mm thick MR Grade plywood confirming to IS:303 grade. The exposed surface to be covered with 1mm thick laminate of approved shade & make. Edges are to be covered with teak wood beeding with polish, cost inclusive of all materials,	1.00	NO		

Signature of Bidder with seal

Premises & Estate Section,  
Circle Office Hubballi  
Centrum Building,

Page 17 of 18

**ಸಿಂಡಿಕೇಟ್ ಸಿಂಡಿಕೇಟ್ Syndicate**

NIT Ref. COHUB: P&E:DPJ:10816: 2024-25 dated 06.07.2024

	labour charges, hinges etc.				
25	<b>ALUMINIUM COMPOSITE PANELLING :</b>				
	Providing and fixing ACP for external wall cladding using 4mm thk ACP with aluminium foil thickness of 0.50mm on bothsides and 3mmthk polyethylene core of Euro Bond, Aluco Bond, Aluco panelmake. The panel should be of PVDF paint coating of Bank approved colour and shade,it shouldwithstand for atleast 15years for fading (warranty certificate from the manufactrers is to be given for 15 years against fading, chalking. and delaminations etc) and to be properly fixed to the plywood backing . The Panels will be fixed on aluminium profiles framing fixed securely to the masonry wall. ACP should be fixed to the framing using suitable rivets /screws of suitable size. The rate should include all the material, labour,wastage, scaffolding etc. complete. Payment will be made on sq.ft. basis of actual finished area. <b>Note-</b> Combination of various shades should be used as per Bank design wherever necessary.	150.00	SFT		
26	<b>DB COVER BOX :</b>				
	Supplying and fixing DB cover Box with front opening with door & lock, and with ventilation provision, all made out of 19mm MR grade block board. The top, front and side surfaces laminated with 1mm lamination and remaining surfaces neatly painted with two coats of synthetic enamel paint over a coat of primer . The overall size shall be 5' (L) x 12" (D) x 10' (H).	43.00	Sft		
27	Demolishing /dismantling of all type of existing partitions, Running counters, loose counters, all types of furniture & fixtures, work stations, Interior items, fixed & loose items, as per directions etc. and any other material required for working on site & compliance of all the activities on site The quoted amount shall also include the removal of debris from site on day to day basis including removing the same with utmost care to ensure no damage in case of reusable fixtures, fittings, accessories & materials of all types including handing over the same to the Bank or shifting the same to a new desired place and re-fixing the same if desired under the instructions and directions of the Consultant or Bank's Engineer-in-charge <b><u>(contractors to visit the site)</u></b>	1.00	Job		
	<b>Total ex GST</b>				