

Carpet Area = 1,897.75 sft

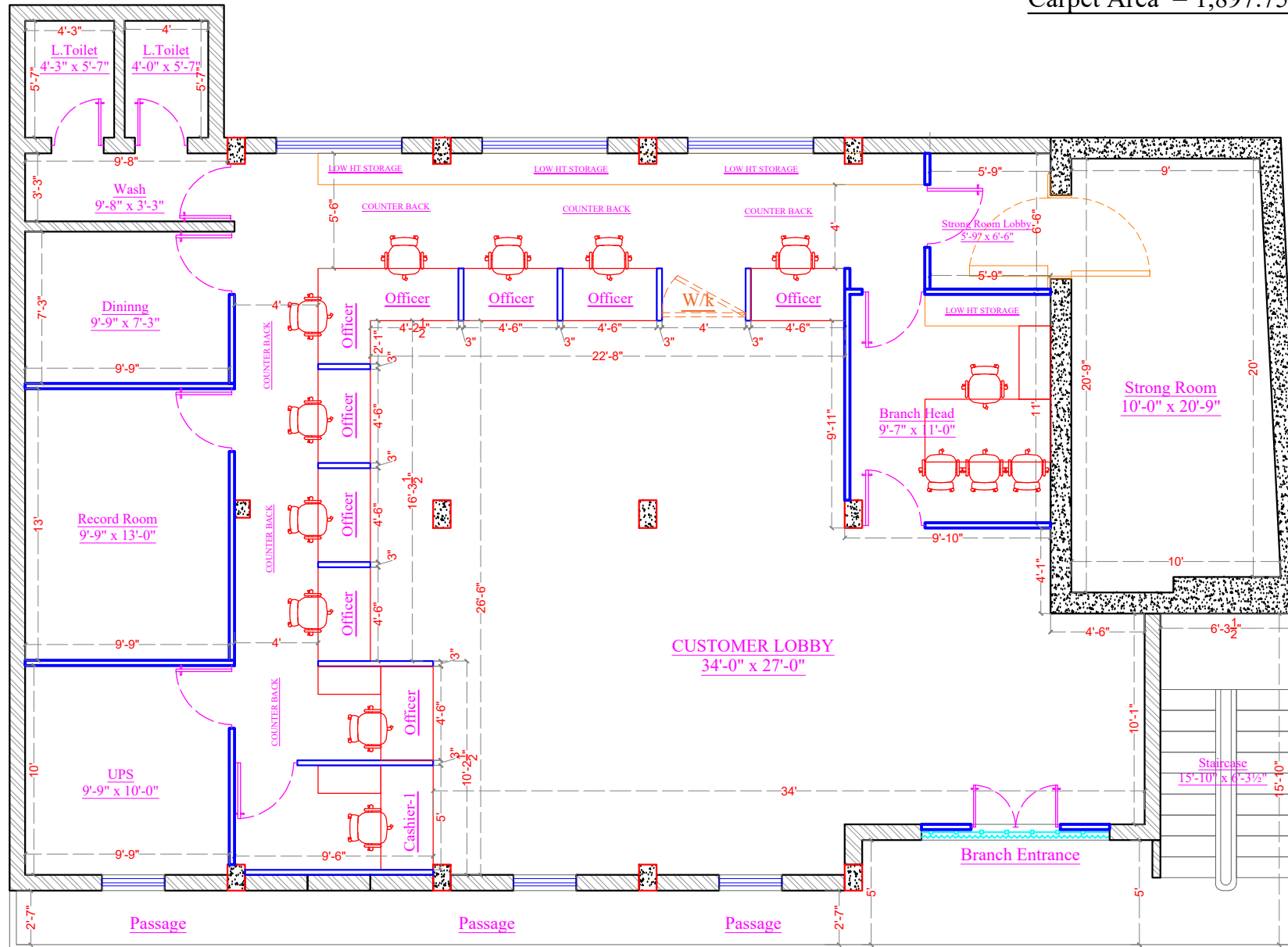

PROJECT:

**Proposed Interior Layout Plan For
Canara Bank at Vivekanand
Nagar Branch.**

SHEET TITLE:

PROPOSED INTERIOR LAYOUT PLAN

1. This Drawing is the property of Design Integration No portion of this drawing should be copied or used elsewhere without the permission of the Architect.
2. Only written dimension to be followed and should not be scaled.

OPTION-1

Date: - 19-07-2024

Dealt :- Pavan Konga

Checked :- Akash

Sheet No :- 01



DESIGN INTEGRATION

Hyderabad Office: H.No:1-79/1, Kothapet, Near Balapur, Balapur Mandal, RR District, Hyderabad, Telengana - 500005.

Mob: 8125196178; 9553495945.

E-mail: akash.designintegration@gmail.com

ARCHITECTURE & INTERIORS