

# OPTION- 06

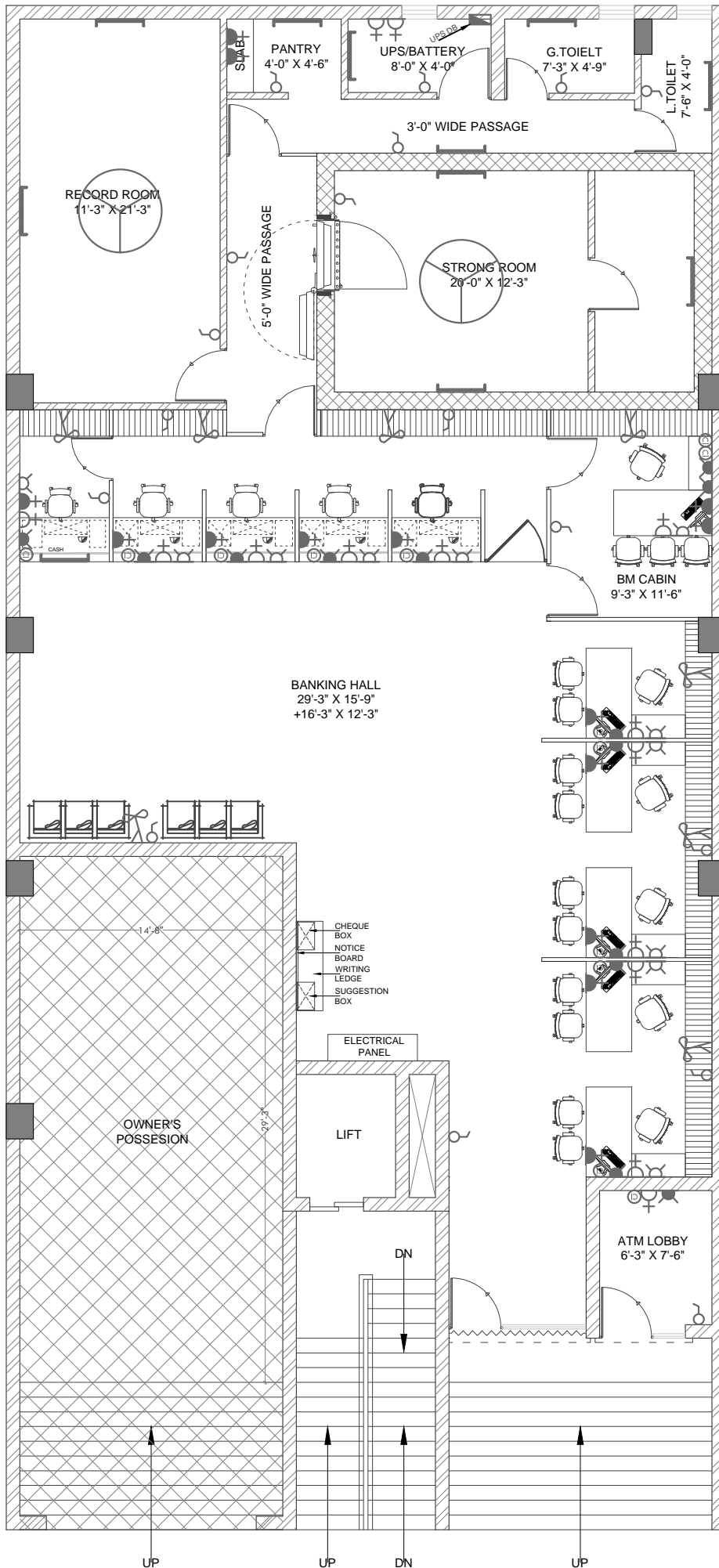

## LEGEND FOR SMALL POWER

SL.NO.	ITEM NAME	HT. FROM FFL.
1	2 NOS. 6A SWITCH & SOCKET RAW LIGHT POINT	3'-0" ABOVE THE COUNTER
2	16A RAW POWER POINT	2'-0" BELOW THE COUNTER
3	TELEPHONE POINT	2'-0" BELOW THE COUNTER
4	DATA POINT	2'-0" BELOW THE COUNTER
5	UPS - 3NOS. SOCKET BELOW TABLE & SWITCH ABOVE COUNTER	2'-0" BELOW THE COUNTER
6	WALL FAN	7'-0"
7	TUBELIGHT	8'-0"
8	EXHAUSTED	7'-0"
9	SWITCH BOARD	3'-0"
10	BELL	7'-0"
11	CEILING FAN	ON CEILING
12	POWER D.B./LIGHT D.B./UPS.D.B.	4'-0"

- GENERAL NOTES:-**
- THIS DRAWING IS THE PROPERTY OF ARCH DESIGN ARCHITECTS AND IS NOT TO BE USED FOR ANY PURPOSE OTHER THAN FOR WHICH IT IS ISSUED WITH OUT PERMISSION OF ITS PRINCIPALS.
  - THIS DRAWING IS TO BE READ IN CONJUNCTION WITH OTHER RELEVANT ARCHITECTURAL, STRUCTURAL AND OTHER SERVICES/ CONSULTANTS DRAWING. IT SHALL BE THE DEEMED RESPONSIBILITY OF THE CONTRACTOR/ FABRICATOR TO BRING IN TO NOTICE OF ARCHITECTS IF ANY DISCREPANCY WITHIN OR BETWEEN THE DRAWINGS PRIOR TO CONSTRUCTION.
  - ALL WRITTEN DIMENSIONS ARE TO BE FOLLOWED AND THE DRAWING IS NOT TO BE SCALED.
  - NOTE- ALL DIMENSION ARE IN FEET UNTIL MENTION IN DWG

**CLIENT:-**  
CANARA BANK,  
CIRCLE OFFICE KARNAL

**PROJECT:-**  
PROPOSED ELECTRICAL LAYOUT  
PLAN FOR CANARA BANK AT  
NIT FARIDABAD

**DRAWING TITLE:-**  
INTERIOR LAYOUT PLAN  
FOR GROUND FLOOR

SCALE:-	NORTH:-
DWG. NO.:-	N.T.S.
DATE:-	ADA-CB-NIT-01
	15.02.2024

**ARCH DESIGN ARCHITECTS**

ARCHITECTS INTERIOR DESIGNER LANDSCAPE CONSULTANTS  
GANPATI NIWAS, CIVIL LINES, BSR MOB: 9899227440, 9412857600, 8882829762