

PROJECT.

**MODIFIED BUILDING
& INTERIOR LAYOUT
PLAN OF THE
"CANARA BANK"
BRANCH - KATHGHARIYA
R/O :- HALDWANI**

OPTION :- 04

DATE :- 02-SEPT.2024 - MONDAY

SPACE FOR OFFICE USE:-

DETAIL OF AREA CHART

in Sq.ft.s.

CARPET AREA FOR BANK.	1554.66
CARPET AREA FOR A.T.M.	0035.87
TOTAL CARPET AREA.	1590.53
CARPET AREA OF TOILET'S (NOT COUNTING IN CARPET AREA)	0060.62

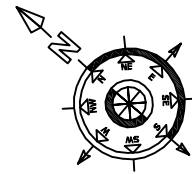

FLOOR NO.- GROUND FLOOR

EXISTING HEIGHT WITHOUT SLAB: -	
UP TO BEAM	09'-10"
FULL HEIGHT	11'-09"

ANY INQUIREY / INFORMATION
CONTACT TO: -Er.ABDUL MANNAN
MOB.09997339956,09837933338

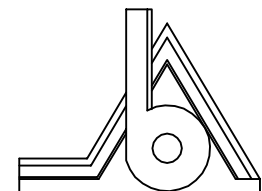

BAJAJ & ASSOCIATES
ESTD : 1972

Ar.MANMEET SINGH BAJAJ

M/S BAJAJ & ASSOCIATES
ARCHITECT, ENGINEERS PLANNERS & VALUERS,
SOPHIA MARKET COURT ROAD, SAHARANPUR-247001
TEL.No.- 0132-2724396,098970-86906, 098370-23300
email- manmeet225@yahoo.com

CORPORATE OFFICE :- B-24 GROUND FLOOR
,SEC-44,NOIDA-201301(U.P.)

BRANCH OFFICE :- (01)- H.NO. 197/ 8 / 1 RAJPUR ROAD
,DEHRADUN -248001 (U.K)
(02)- 333 LANE NO 02, SIYA RAM VIHAR
,NEAR INDIAN OIL PUMP, TAKROHI,
INDIRA NAGAR, LUCKNOW 226016(UP)
(03)- H.NO. 5 / 1 A, Aman NAGAR, opp
DMW workshop,Patiala

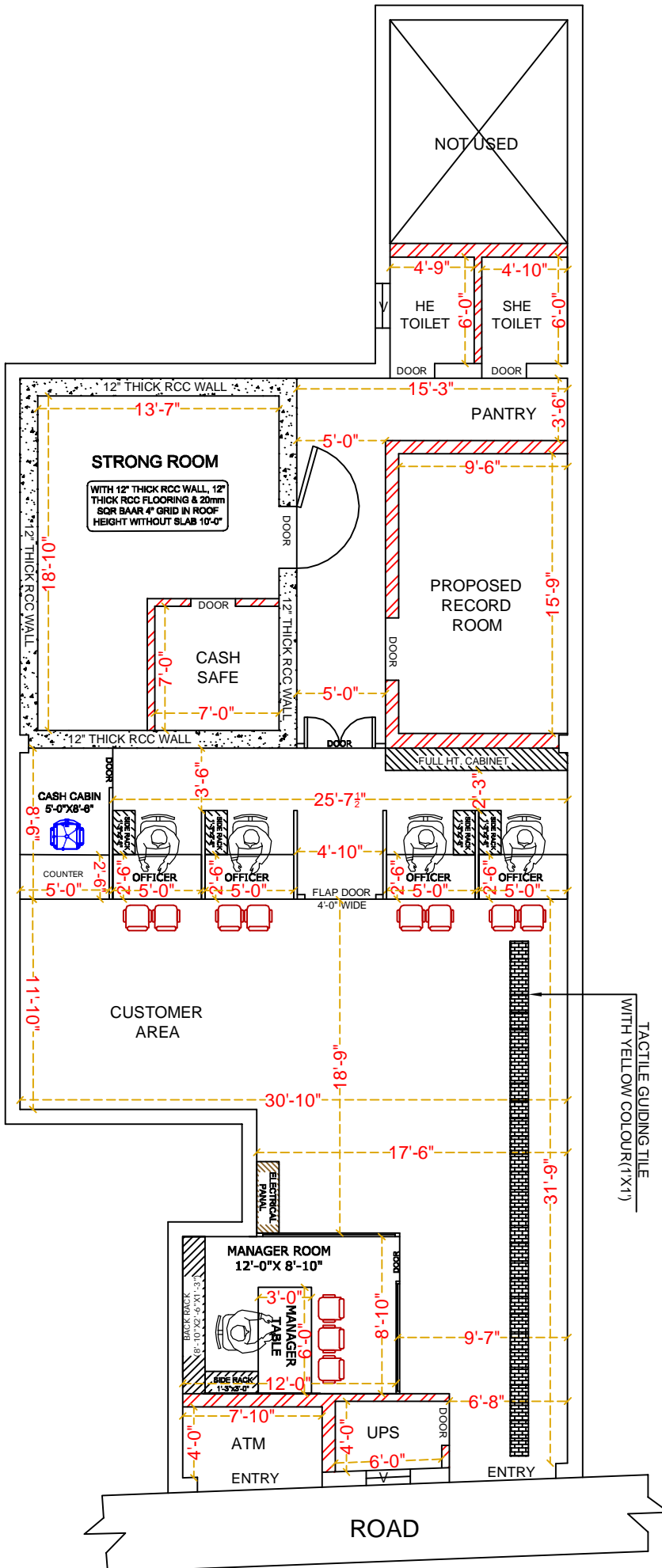

MODIFIED BUILDING PLAN