

system

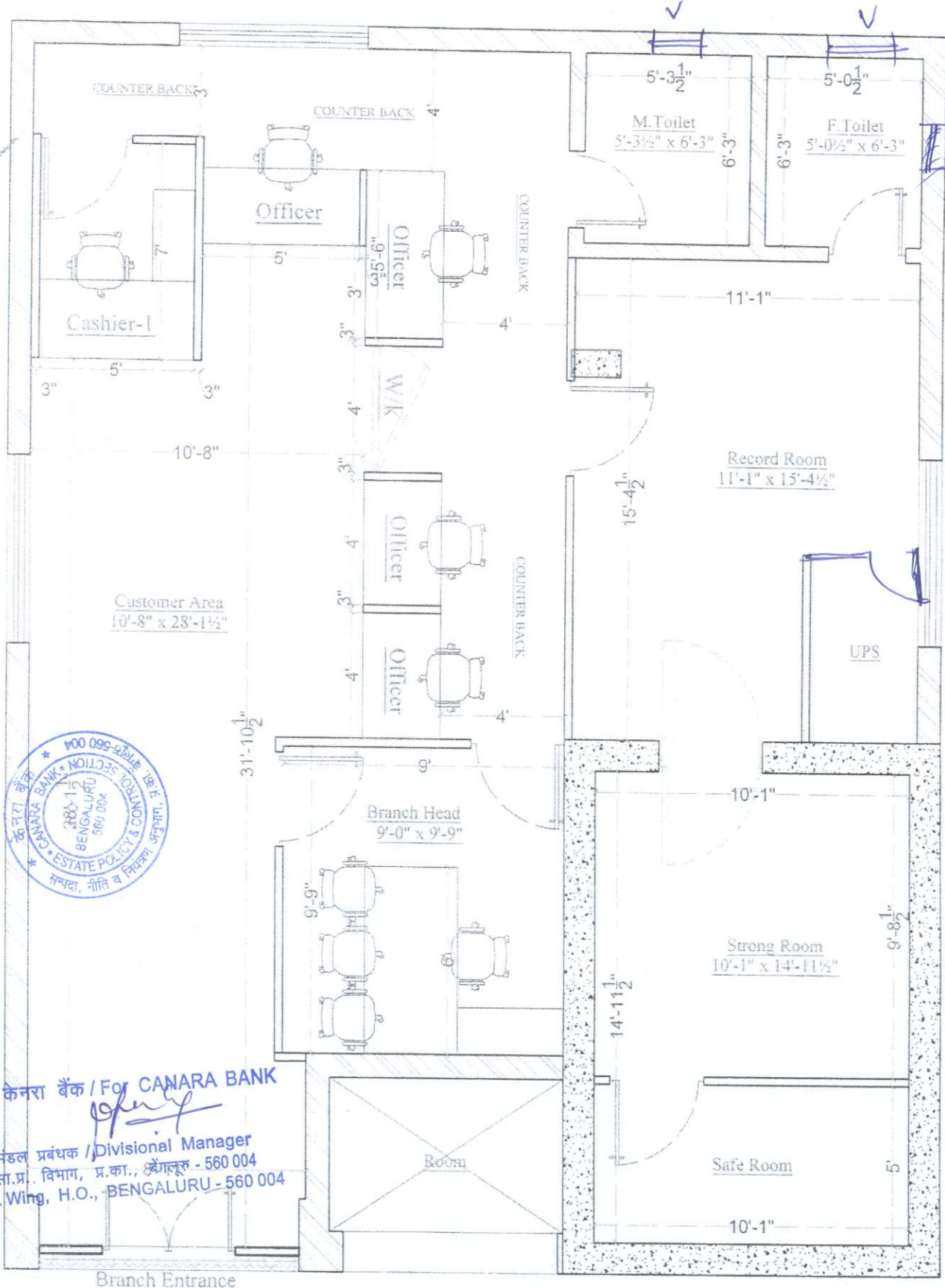

कृते केनरा बैंक / For CANARA BANK
 मंडल प्रबंधक / Divisional Manager
 सा.प्र. विभाग, प्र.का., बंगलूरु - 560 004
 G.A. Wing, H.O., BENGALURU - 560 004

Carpet Area - 1,002.00 sft

PROJECT Proposed Interior Layout Plan For Canara Bank at Muluvanka Branch.	SHEET TITLE PROPOSED INTERIOR LAYOUT PLAN	OPTION-1 Date - 06/06/2024		
	1. This Drawing is the property of Design Integration. No portion of this drawing should be copied or used elsewhere without the permission of the Architect. 2. Only written dimension to be followed and should not be scaled.	Draft - Pravin Kanga Checked - Akash Sheet No - 01		

Layout is Approved Subject to compliance of observations made vide Ref. No. 811/2024-25 Date: 11/06/2024