

**AREA CALCULATION**

Total Area : 1805.00  
Toilet Area : 30.00

Total Area : 1835.00  
Toilet Area : - 30.00

Carpet area : 1775.00 Sft

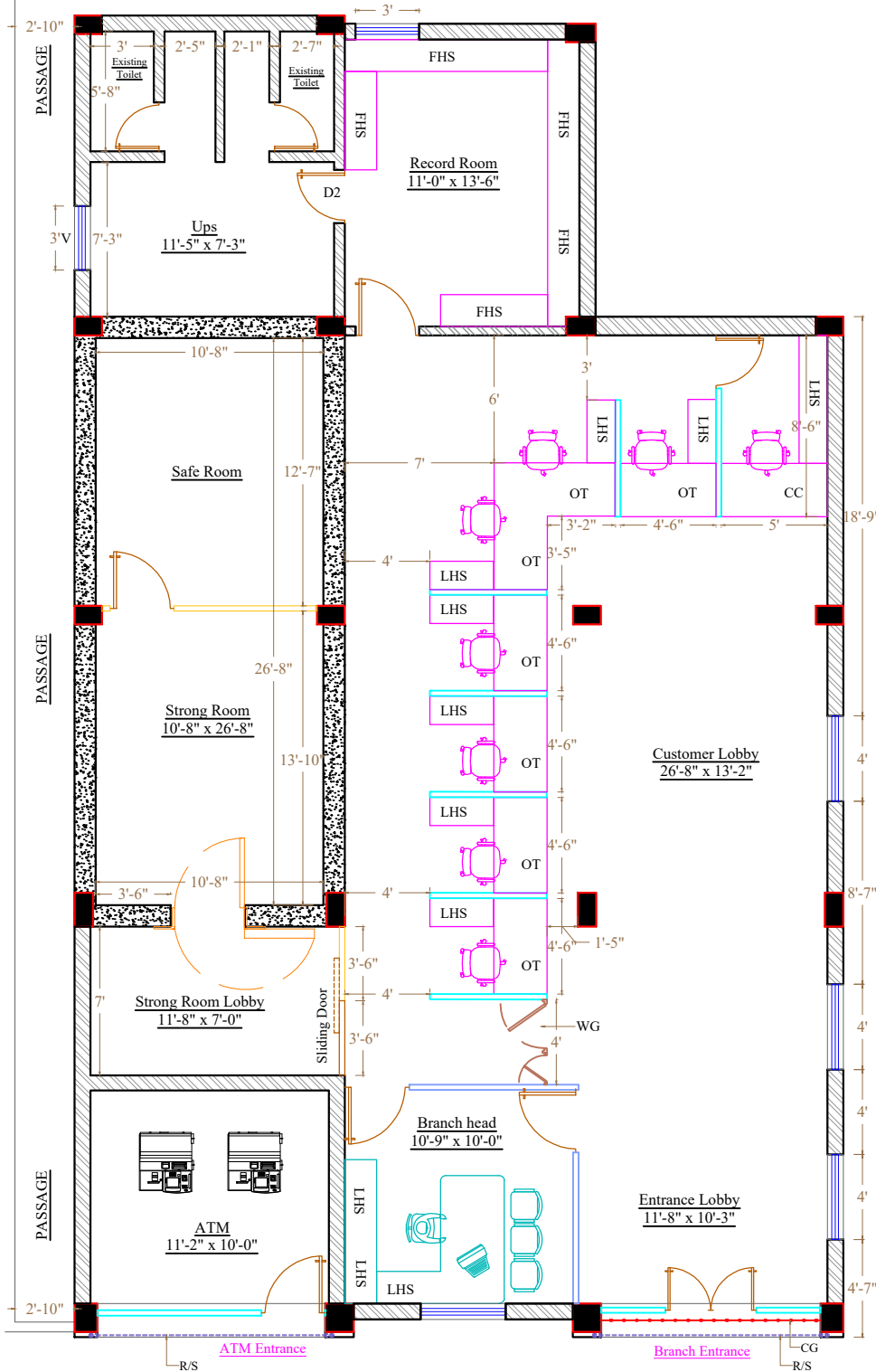

- ▨ PGP - Partly glazed partition
- ▨ SP - Solid partition
- ▨ GP - Glass partition
- ▨ V - Ventilator - 2'x1'6"
- ▨ D - Door - 3'0"x7'
- ▨ D2 - Door - 2'6"x7'
- ▨ MD - Door - 2'6"x7' X 2 Nos
- ▨ LHS - Low height storage - L x 1'6" Width x 2'6" height
- ▨ LHS-1 - Low height storage - L x 1'6" Width x 4'0" height
- ▨ FHS - Full height storage - L x 1'6" Width x 8'0" height
- CC - Cash counter table - 5'0" x 2'6"
- OT - Officer counter table - 4'6" x 2'6"
- MT - Manager table - 6'0" x 3'0"
- WG - Wicket gate - 4'0" x 2'6"
- R/S - Rolling shutter
- CG - Collapsible / Grill gate

NOTE: 1) All Dimensions are in feet & inches  
2) Do not scale the Dwg, Only written Dimensions are to be followed

REV	DESCRIPTION	DATE
PROJECT : PROPOSED BRANCH & ATM At CHOUTUPPAL		
CLIENT : CANARA BANK		
DWG TITLE : PROPOSED LAYOUT		
DATE : 07-10-2024	DRAWN : A. RAHMAN	
OPTION : OP-2	CHECKED : K.N.C	
SCALE : N.T.S	APPROVED : K.N.C	

OWNERS SIGNATURE