

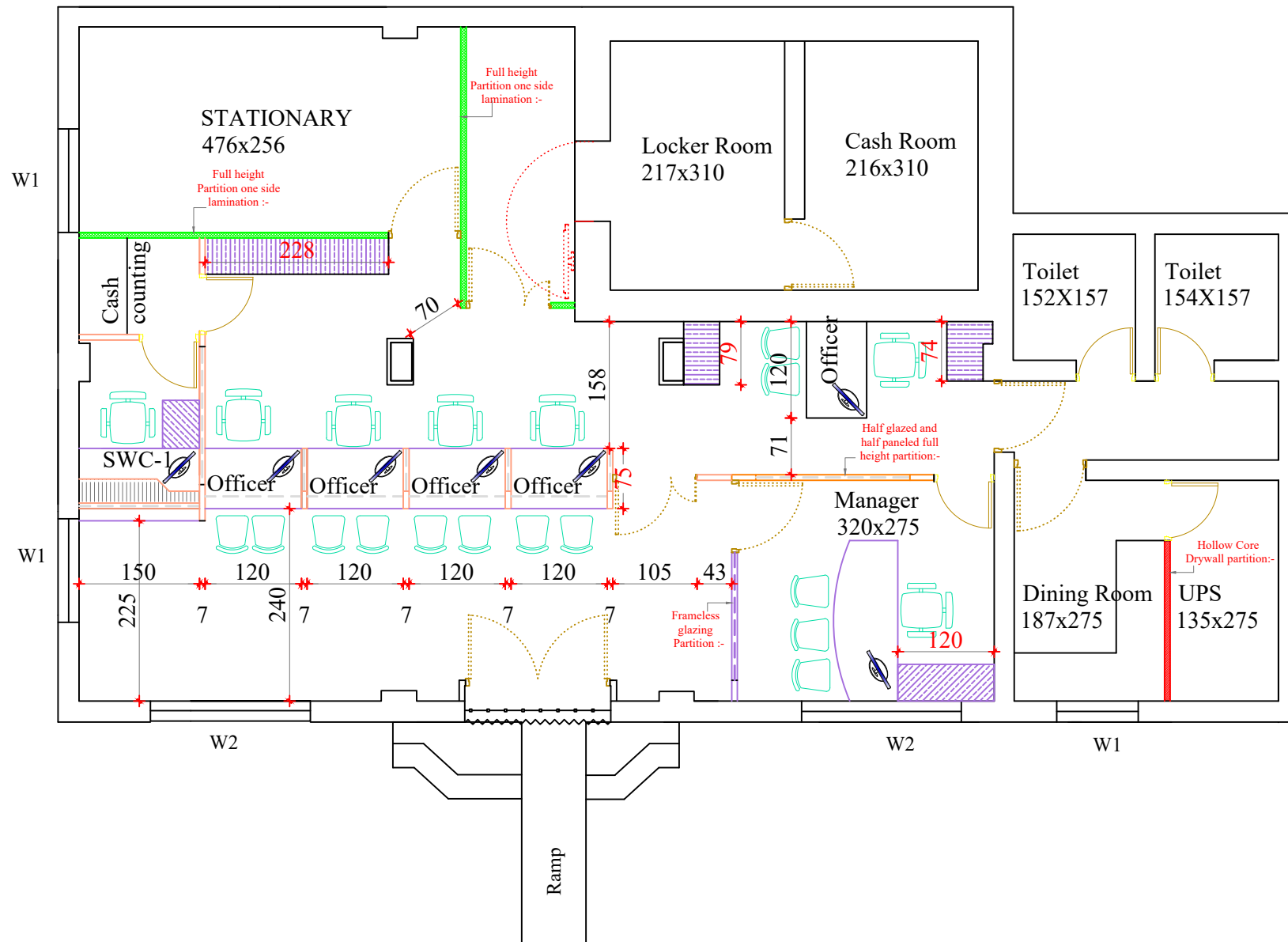

BEAM HEIGHT - 259 CM
 SLAB HEIGHT - 289CM

AREA CALCULATION

| | |
|---------------|---------------|
| CUSTOMER AREA | - 19.76 Sqm |
| BANKING AREA | - 39.22 Sqm |
| DINING /UPS | - 9.05 Sqm |
| STRONG ROOM | - 13.42 Sqm |
| STATIONARY | - 17.48 Sqm |
| PASSAGE | - 3.24 Sqm |
| TOTAL | - 102.17 Sqm |
| | - 1099.35 Sft |



| | | | |
|------------|-------|-----------|--------------|
| Scale | : NTS | Date | : 24/05/2023 |
| DC | : | Dealt | : |
| Checked | : | Drawn By: | Sujesh |
| Drawing No | : 01 | Job no | : |

ALL DIMENSIONS ARE IN CENTIMETERS

Title : THRIKKUR

Name of work:
 PROPOSED LAYOUT - I

Clients Signature-

Client :
 CANARA BANK
 BRANCH OFFICE
 TRIKKUR

Architects Signature & seal :-

Architect :
Prima Arch
 Head office
 (Architect, CA, 84 8733, REG Valuer-F-3047)
 359 - E, 1st Floor
 Convent Road, Cherthala - 688 524
 PH - 0478 - 2820159
 E-mail primaarch@gmail.com