

Option:-04

NOTE

- HALF HT PARTITION
- 7' HT PARTITION
- GLAZED FULL HT PARTITION
- SOLID FULL HT PARTITION

TOTAL INTERNAL BRANCH AREA = 2207.00sqft.(Approximate)
 TOTAL CARPET AREA (BRANCH+ ATM) = 2130.00sqft.(Approximate)

CANARA BANK

AT = MUNGER BRANCH

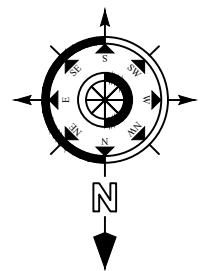

PROJECT:-

PROPOSED INTERIOR LAYOUT OF
CANARA BANK
 AT- **MUNGER BRANCH**

REVISION:-

Date :-	

Sheet title :-
FURNITURE LAYOUT PLAN

Scale :-	Date :-	Drawn by :-	Checked by :-
N.T.S	30/05/2023	rahulsingh	Ar. Amit Kumar

ARCHITECT :-

ARTCON DESIGN CONSULTANTS
 ARCHITECTS ENGINEERS
 INTERIOR DESIGNERS COMPUTER AIDED DESIGN
 G-04 Laxmi Palace, Mitra Compound, Boring Road, Patna - 800001
 +91 9931723771 amitkumar73@gmail.com
 +91 9386717726 artcondesignconsultants.com

GROUND FLOOR PLAN

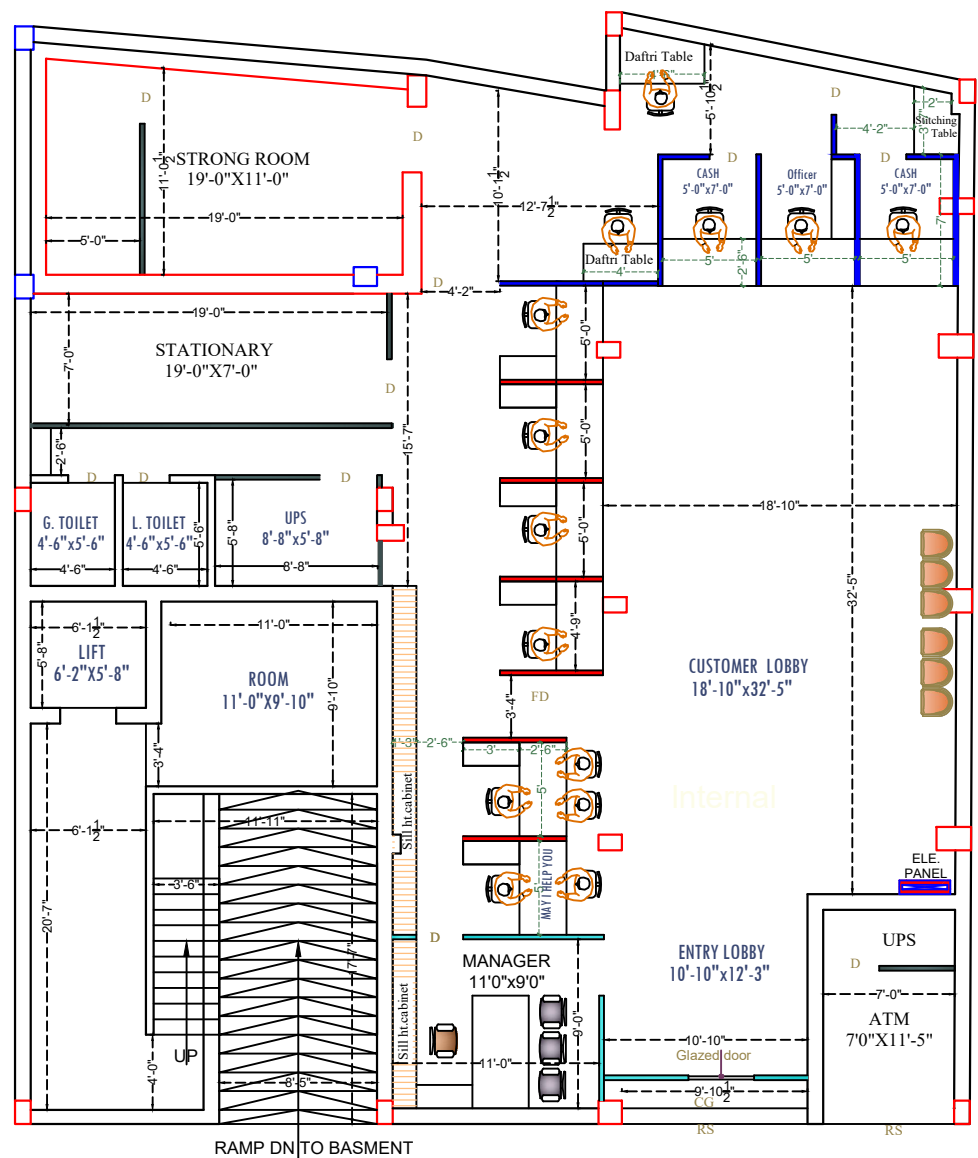

M A I N R O A D