

PROJECT.

MODIFIED BANK BUILDING
& INTERIOR LAYOUT
PLAN OF THE
"CANARA BANK"
BRANCH - "CHUHAR MAJRA"
HARYANA

OPTION :-01

DATE :- 25.04.2024 - THURSDAY

SPACE FOR OFFICE USED:-

DETAIL OF AREA CHART

IN SQ.FTS.

CARPET AREA AT GROUND FLOOR

804.69

CARPET AREA FOR ATM

040.13

TOTAL CARPET AREA.

844.82

CARPET AREA OF TOILET'S
(NOT COUNTING IN CARPET AREA)

048.87

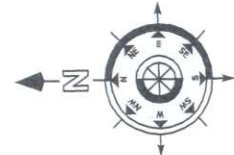

CANARA BANK

FLOOR NO.- GROUND FLOOR

EXISTING HEIGHT WITHOUT SLAB:-

UP TO BEAM 08'-03"

FULL HEIGHT 11'-01"

ANY INQUIRY / INFORMATION TO CONTACTS:- Er. ABDUL MANNAN
MOB. 09837933338-09997339956



Ar.MANMEET SINGH BAJAJ

M/S BAJAJ & ASSOCIATES
ARCHITECT, ENGINEERS PLANNERS & VALUERS,
SOPHIA MARKET COURT ROAD, SAHARANPUR-247001
TEL.No. - 0132-2724396, 098970-68906, 098370-23300
email- manmeet225@yahoo.com

CORPORATE OFFICE :- B-24 GROUND FLOOR
SEC-44, NOIDA-201301(U.P.)

BRANCH OFFICE :- H.NO. 197/ 8 / 1 RAJPUR ROAD
DEHRADUN -248001 (U.K)

BRANCH OFFICE :- 333 LANE NO 02, SIYA RAM VIHAR
NEAR INDIAN OIL PUMP, TAKROHI,
INDIRA NAGAR,
LUCKNOW 226016(UP)

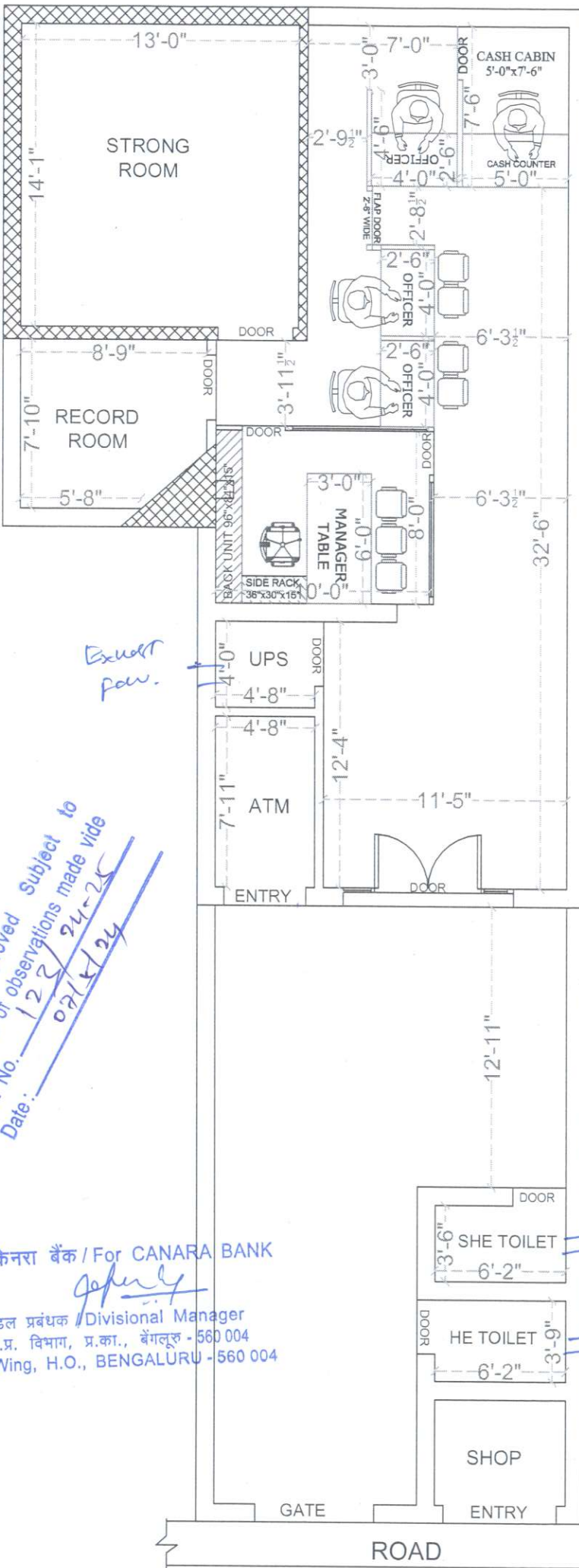

Exhaust fan.

*Layout is Approved Subject to
Compliance of observations made vide
Ref. No. 123/24-25
Date: 07/5/24*

कुते केनरा बैंक / For CANARA BANK

gopurly
मंडल प्रबंधक / Divisional Manager
सा.प्र. विभाग, प्र.का., बेंगलूरु - 560 004
G.A. Wing, H.O., BENGALURU - 560 004

ROAD