

MANOJ SHARMA PROPERTY

DETAILS OF PROPOSED AREA CHART		IN.SQFT
CARPET AREA FOR BANK BRANCH		1012.0
BANKING HALL AREA		738.0
CUSTOMER AREA		403.0

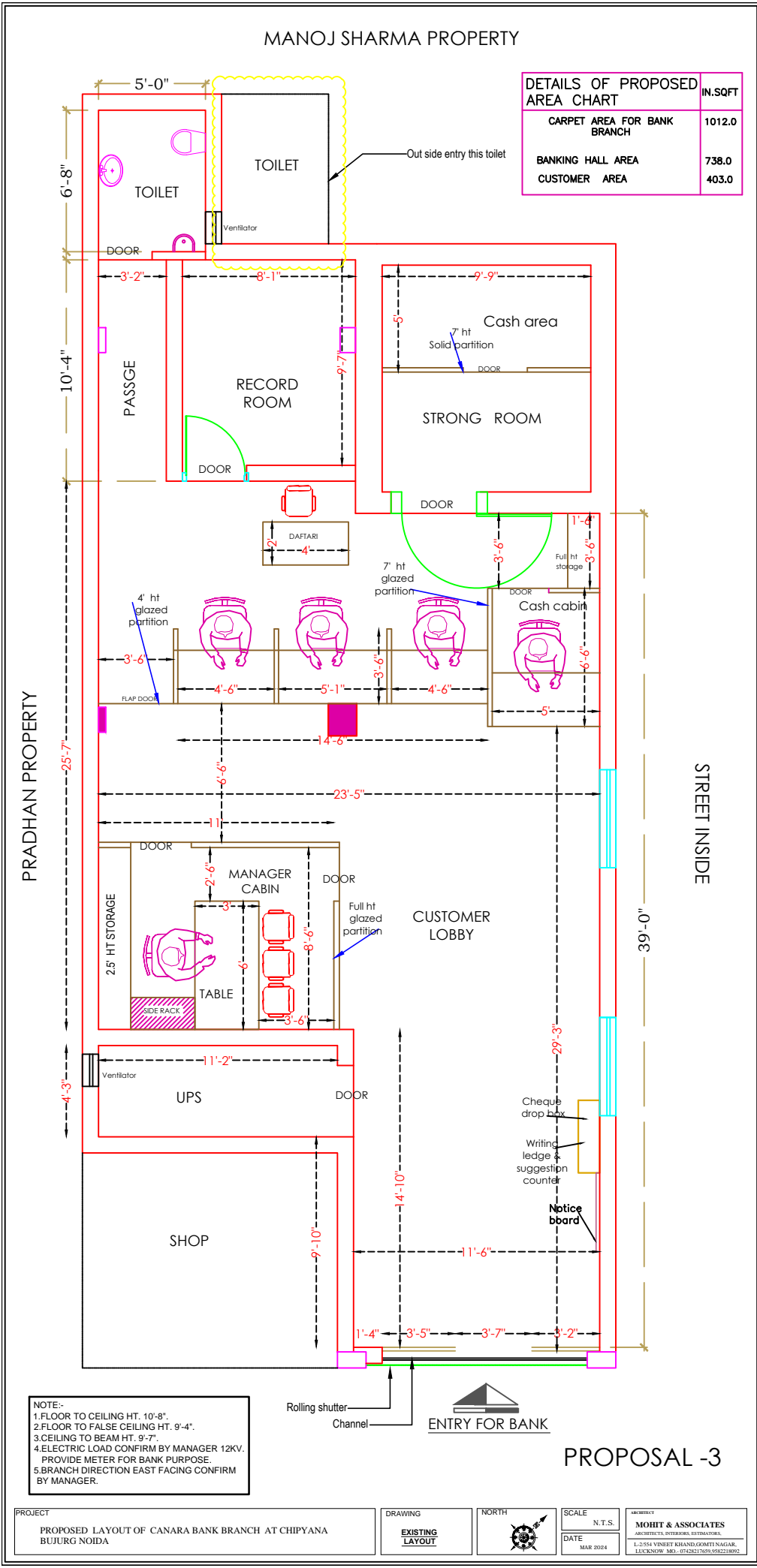

NOTE:-
 1.FLOOR TO CEILING HT. 10'-8".
 2.FLOOR TO FALSE CEILING HT. 9'-4".
 3.CEILING TO BEAM HT. 9'-7".
 4.ELECTRIC LOAD CONFIRM BY MANAGER 12KV.
 PROVIDE METER FOR BANK PURPOSE.
 5.BRANCH DIRECTION EAST FACING CONFIRM BY MANAGER.

PROPOSAL -3

PROJECT PROPOSED LAYOUT OF CANARA BANK BRANCH AT CHIPYANA BIJURJ NOIDA	DRAWING EXISTING LAYOUT	NORTH 	SCALE N. T. S.	ARCHITECT MOHIT & ASSOCIATES ARCHITECTS, INTERIORS, ESTIMATORS E-2854 PINEET KRISHNA GANPATI NAGAR, LIC/KNOW. MO. - 07423617669/926218092
			DATE MAR 2024	