

THIS DRAWING IS THE PROPERTY OF NARENDRA SARDESHPANDE & ASSOCIATES AND ITS USE IN ANY MANNER BY ANY PERSON WITHOUT PERMISSION IS PROHIBITED.

**NOTES :-**

1. ALL LEVELS ARE FINISHED FLOOR LEVELS UNLESS OTHERWISE MENTIONED.
2. THE ARCHITECTURAL WORKING DRAWINGS MUST BE COORDINATED WITH THE RELEVANT DRAWING FROM OTHER CONSULTANTS BEFORE EXECUTION. ANY DISCREPANCY MUST BE BROUGHT TO THE NOTICE OF THE ARCHITECT IMMEDIATELY.

**LEGEND CIVIL ALTERATIONS**

SYMBOL	DESCRIPTION
	PROPOSED BRICK WORK
	WALL TO BE DIMOLISH
	P.O.P. PUNNING ON WALL
	PLASTER ON WALL

CARPET AREA =

OCCUPANCY TABLE			
SR. NO	DESCRIPTION	OCCUPANCY	
		REQUIRED	PROVIDED
1.			
2.			
3.			
4.			
5.			
6.			

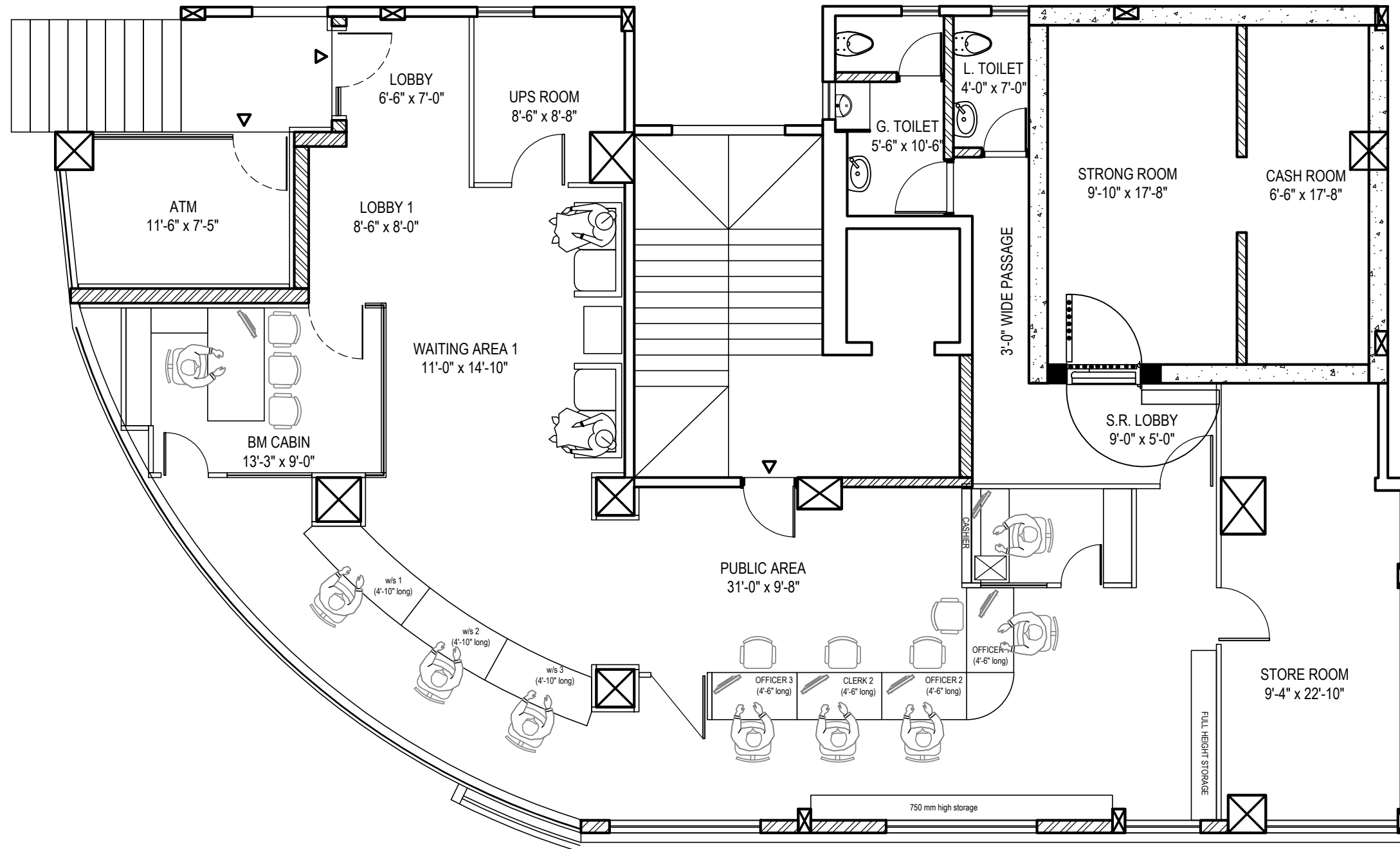

CARPET AREA OF BRANCH = 177.28 sq. m. = 1908.24 sq. ft.

CARPET AREA OF ATM = 8.25 sq. m. = 88.80 sq. ft.

TOTAL CARPET AREA = 185.53 sq. m. = 1997.04 sq. ft.

PROJECT: - **PROPOSED INTERIOR DESIGN OF KARVE ROAD BRANCH**

CLIENT:- **CANARA BANK**

SITE: - **BUSINESS CENTRE, KHILARE PATH, ERANDWANE, PUNE**

**NSA**  
**NARENDRA SARDESHPANDE & ASSOCIATES**  
**Architects**  
 43, "Shreeku", Flat No.2, Ground Floor, United Western Hsg. Society, Near Tothawade Garden, Karvenagar, Pune-411052  
 Tele:-(020) 2545 42 97. E-mail : nsapune1@gmail.com

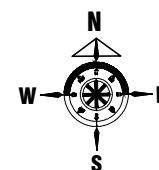

DRAWING CATEGORY		SHEET	
		<b>SCHEME DRAWING</b>	
SD	(B)	01	R5
SCALE		1:75	
JOB NO.	DATE	DRAWN BY	REVISED BY
223-35	29.03.2024	NS	