

OPTION - 02

ROAD

ROAD

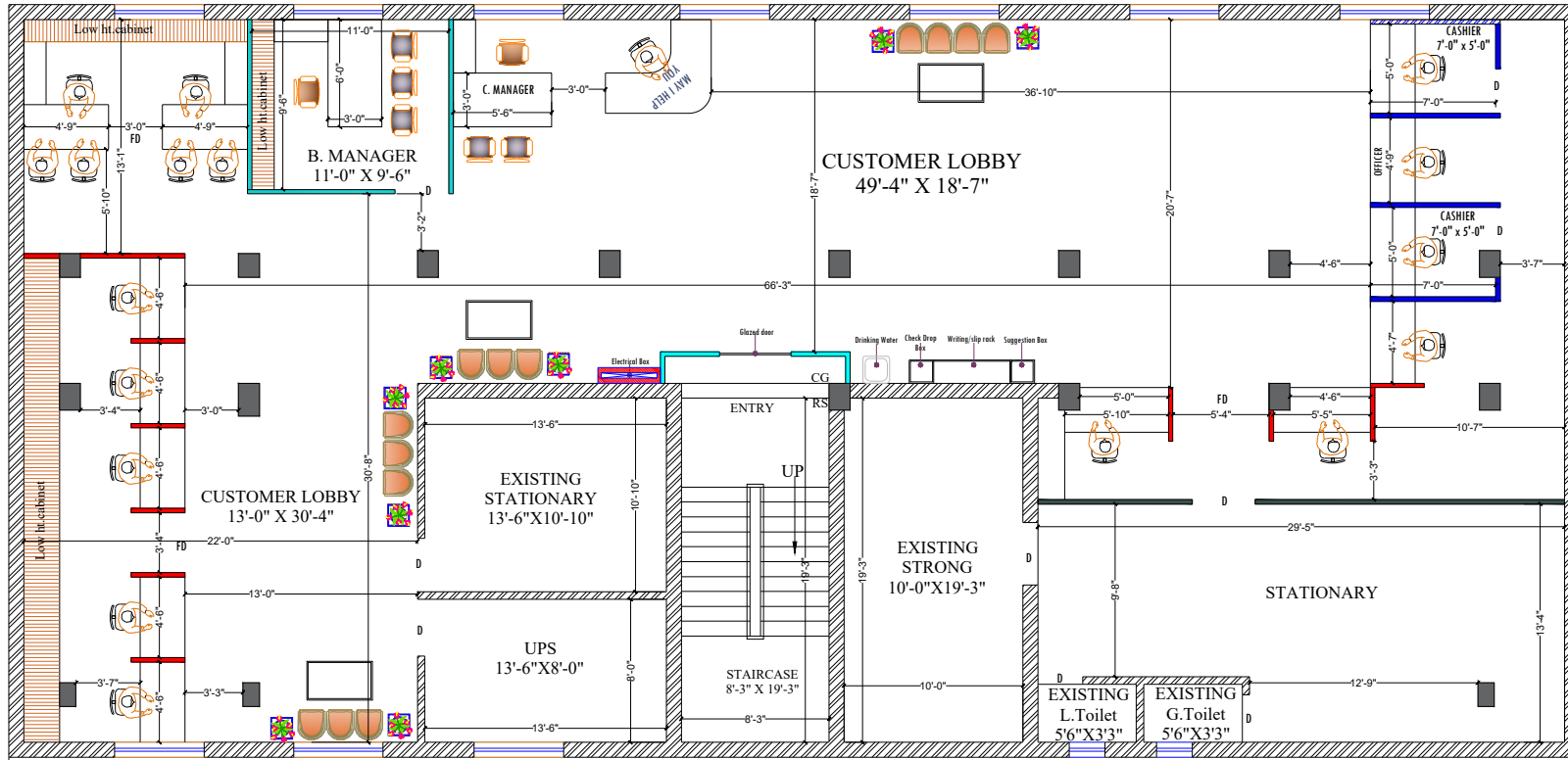

FIRST FLOOR PLAN

NOTE

- HALF HT PARTITION
- 7' HT PARTITION
- GLAZED FULL HT PARTITION
- SOLID FULL HT PARTITION
- COLUMN
- CASH CABIN SIDE WALL PANNELLING

TOTAL CARPET AREA BRANCH = 3219.22 sq ft. (Approximate)  
 BANKING HALL AREA = 2507.02 sq ft. (Approximate)  
 CUSTOMER LOBBY AREA = 1621.02 sq ft. (Approximate)



PROJECT:-

PROPOSED INTERIOR LAYOUT OF  
**CANARA BANK**  
 AT- **KANKARBAGH BRANCH**

REVISION:-

|  |
|--|
|  |
|  |
|  |
|  |

Sheet title :- **FURNITURE LAYOUT PLAN**

|          |            |              |                |
|----------|------------|--------------|----------------|
| Scale :- | Date :-    | Drawn by :-  | Checked by :-  |
| N.T.S    | 21/05/2024 | ANIKET ANAND | AR. AMIT KUMAR |

ARCHITECT :-



**ARTCON DESIGN CONSULTANTS**  
 ARCHITECTS - ENGINEERS  
 INTERIOR DESIGNERS - COMPUTER AIDED DESIGN  
 G-04 Laxmi Palace, Mitra Compound, Boring Road, Patna - 800001  
 +91 9931723771, amikumar73@gmail.com  
 +91 9386717726 artcondesignconsultants.com